

Smooth Products – Outside Corner (OCS) 135° Stud

DESCRIPTION

OCS (Outside Corner) 135° Studs are made of galvanized steel and available in 22 gauge (27 mil) to 16 gauge (54 mil) thicknesses. They have two 2" faces bent to a 135° inside angle, with 90° flange of 1.25" (or 1.625" for 18 & 16 gauge) and 90° lip returns of 0.3" for stiffness.

MATERIALS

Outside Corner Studs sections are fabricated from hot dipped galvanized steel conforming to ASTM A653-02a or equal.

COLOR CODE

Traditional	Elite
25 Gauge – Clear (No Paint)	25TI Gauge – Clear/White Stripe
24 Gauge – Orange	20TI Gauge – Clear/Red Stripe
22 Gauge – Black	30ED Gauge – Red and Blue
20D Gauge – Pink	33ES Gauge – Purple
20S Gauge – White	43ES Gauge – Brown
18 Gauge – Yellow	54ES Gauge – Light Blue
16 Gauge – Green	
14 Gauge – Orange	
12 Gauge – Red	
10 Gauge – Blue	

ASTM & CODE STANDARDS

- IBC 2009/2012
 - AISI NASPEC 2007
 - Meets or exceeds:
 - ASTM C754 & ASTM C645
 - ASTM E119 & E90
 - ASTM A370
 - ASTM A1003
 - ASTM C1513
- Please reference Steeler ICC-ES Report ESR-2054 for further information. Available for download at www.steeler.com/technicalinfo.php

MANUFACTURER CONTACT INFORMATION

Seattle Plant | 10023 MLK Jr. Way S. Seattle, WA 98178 | P: 206-725-2500

Newark Plant | 6851 Smith Ave. Newark, CA 94560 | P: 510-505-9574

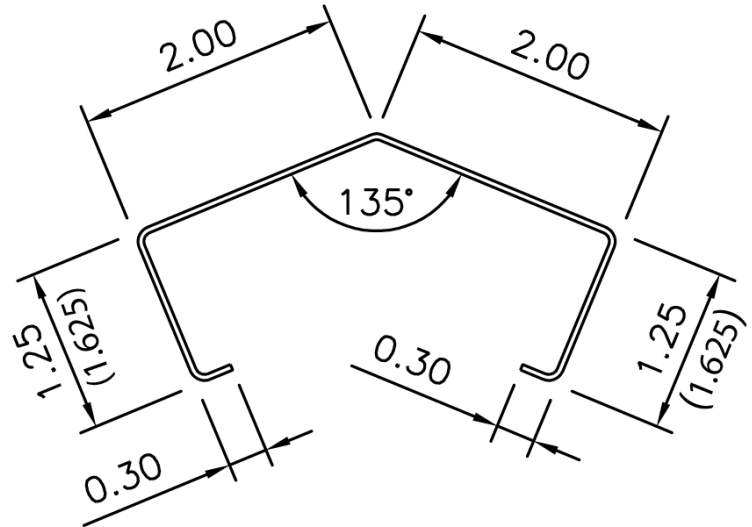

400 OCS 135-XX

STEELER LEED® INFORMATION

LEED Credit MR 2: Steeler framing products are manufactured from cold-formed steel (CFS). CFS is 100% recyclable and therefore contributes significantly to LEED Credit MR 2. The specific contribution amounts will vary depending on the project and construction decisions.

LEED Credit MR 4: Steeler framing products contain a minimum of 26% post-consumer and 7% pre-consumer recycled steel content for a minimum of 33% recyclable. Recycled content of materials contributes to LEED Credits MR 4. If notified in advance, Steeler can order steel containing higher percentages of recycled content to meet your specific project needs. Contact Steeler technical services prior to ordering so we can help support your project goals.

Gross Property Tables – Smooth Products ICS

Effective Properties

Limiting Heights

Member ID	Gauge	T, in	A, in ²	WT, plf	Ix, in ⁴	rx, in	ly, in ⁴	ry, in	FY = 33 KSI			5 PSF, L/120, FY = 33 KSI			
									Maxo k-in	Ixe in ⁴	Sxc(t) in ³	Sxc(b) in ³	12"OC	16"OC	24"OD
400 ICS 135-27	22	0.0283	0.1927	0.6553	0.0658	0.5841	0.3148	1.2781	1.2120	0.06321	0.07458	0.06133	11.83'	10.75'	9.39'
400 ICS 135-30	21	0.0312	0.2121	0.7211	0.0720	0.5828	0.3457	1.2768	1.3488	0.07189	0.08721	0.06830	12.35'	11.22'	9.80'
400 ICS 135-33	20	0.0346	0.2347	0.7979	0.0793	0.5813	0.3817	1.2753	1.4865	0.07931	0.09640	0.07522	12.76'	11.60'	10.13'
400 ICS 135-43	18	0.0451	0.3038	1.0329	0.1011	0.5767	0.4906	1.2708	1.8953	0.10105	0.12302	0.09591	13.84'	12.57'	10.88'
400 ICS 135-54	16	0.0566	0.3764	1.2799	0.1225	0.5705	0.6012	1.2637	2.3072	0.12250	0.15014	0.11676	14.75'	13.41'	11.71'