

## Pony Wall Support

### DESCRIPTION

**Pony Wall Supports** are made with a 14 gauge (68 mil) G60 C channel welded to a mild steel bottom plate. The bottom plate is 3/8" thick x 16" long x 2-1/2" or 3-1/2" wide with 6 pre-drilled 9/16" holes for anchors. The welded area and bottom plate are painted for corrosion resistance. The upright 14 ga C channels have webs of 2-1/2" or 3-1/2" with 2" flanges and 1/2" returns, and come in stock lengths of 30", 40" and 48" (custom lengths up to 120" are available).

### ASTM & CODE STANDARDS

- IBC 2009/2012
- AISI NASPEC 2007
- Meets or exceeds:
  - ASTM C754
  - ASTM E119 & E90
  - ASTM A370
  - ASTM A1003
  - ASTM C1513 & C955

Please reference Steeler ICC-ES Report ESR -2054 for further information. Available for download at [www.steeler.com/technicalinfo.php](http://www.steeler.com/technicalinfo.php)

### MANUFACTURER CONTACT INFORMATION

Seattle Plant | 10023 MLK Jr. Way S. Seattle, WA 98178 | P: 206-725-2500

Newark Plant | 6851 Smith Ave. Newark, CA 94560 | P: 510-505-9574

### MEMBER DESIGNATION

EXAMPLE: 350P200-68  
 350=3.50" WEB DEPTH  
 P=PONY WALL SUPPORT  
 200=2" FLANGE WIDTH  
 68=68 mils (0.0713")

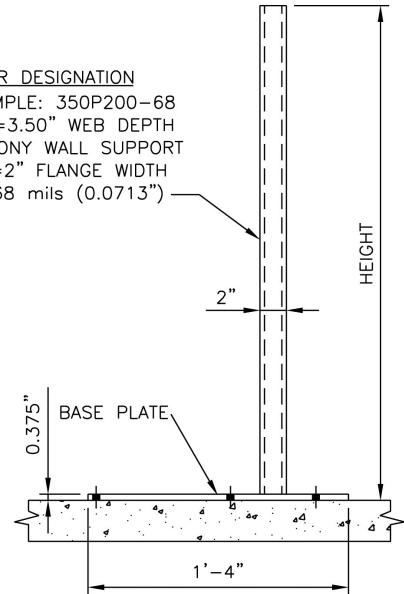

### NOTES:

1. ANCHOR BOLTS 1/2"Ø HILTI KWIK BOLTS 3 WITH 3.50" MIN. EMBEDMENT.
2. MINIMUM CONCRETE STRENGTH  $f'c=2500$  PSI

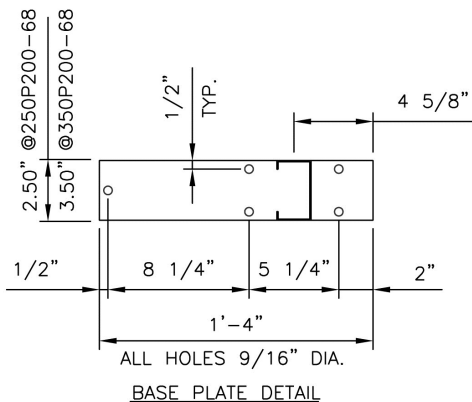

### STEELER LEED® INFORMATION

**LEED Credit MR 2:** Steeler framing products are manufactured from cold-formed steel (CFS). CFS is 100% recyclable and therefore contributes significantly to LEED Credit MR 2. The specific contribution amounts will vary depending on the project and construction decisions.

**LEED Credit MR 4:** Steeler framing products contain a minimum of 26% post-consumer and 7% pre-consumer recycled steel content for a minimum of 33% recyclable. Recycled content of materials contributes to LEED Credits MR 4. If notified in advance, Steeler can order steel containing higher percentages of recycled content to meet your specific project needs. Contact Steeler technical services prior to ordering so we can help support your project goals.

### Pony Wall Support Schedule

Member Designation	Height In.	Lateral Load	
		P, lbs.	w, PLF
250P200-68	36	248	13.8
	42	212	10.1
	48	186	7.7
	60	149	5.0
350P200-68	36	416	23.1
	42	357	17.0
	48	312	13.0
	60	250	8.3



For CAD & BIM Drawings, Architectural Specifications and more, find Steeler on:

