

**STEELER® INC.**  
DRYWALL CONSTRUCTION SUPPLY

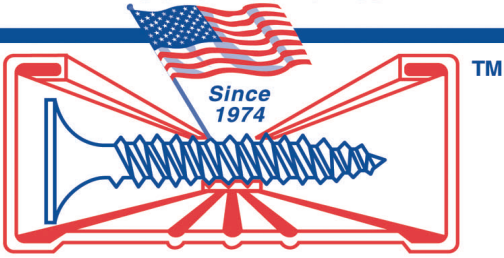

[www.steeler.com](http://www.steeler.com)

# Submittal Cover Page

**MANUFACTURER:**

Steeler, Inc.  
10023 Martin Luther King Jr. Way S.  
Seattle, WA 98178  
Phone: (206) 725-2500  
Fax: (206) 725-1700

Steeler, Inc.  
6851 Smith Ave.  
Newark, CA 94560  
Phone: (510) 505-9595  
Fax: (510) 505-0200

**DATE:** .....

**PROJECT NAME:** .....

**PROJECT LOCATION:** .....

**ARCHITECT:** .....

**CONTRACTOR:** .....

**FRAMING SUBCONTRACTOR:** .....

**CONTACT:** .....



# Product Specification and Submittal Form

Corporate Sales: 800-275-2279  
 Technical Support: 206-760-7100

## Z - Members ( Z FURRING, Z PURLIN)

### MANUFACTURER

Steeler, Inc.  
 10023 Martin Luther King Jr. Way S.  
 Seattle, WA 98178  
 Phone: (206) 725-2500  
 Fax: (206) 725-1700

Steeler, Inc.  
 6851 Smith Ave.  
 Newark, CA 94560  
 Phone: (510) 505-9595  
 Fax: (510) 505-0200

### COLOR CODE

18 mil - Clear  
 24 mil - Brown  
 27 mil - Black  
 30 mil - Pink  
 33 mil - White  
 43 mil - Yellow  
 54 mil - Green  
 68 mil - Orange  
 97 mil - Red  
 118 mil - Blue  
 Painted on ends.

### ASTM & Code Standards

- AISI, North American Specification for the Design of Cold-Formed Steel Structural Members 2001 Edition with 2004 Supplement
- ASTM A370, Standard Test Methods and Definitions for Mechanical Testing of Steel Products
- ASTM A1003, Standard Specification for Sheet Steel, Carbon, Metallic and Non-Metallic Coating for Cold-Formed Framing Members.
- Steeler's structural framing comply with 2006 International Building Code (IBC- 2006)
- ASTM C955, Standard Specification for Structural Steel Framing Members.
- ASTM C754, Standard Specification for Installation of Steel Framing Members to Receive Screw-Attached Gypsum Panel Products.
- ASTM C1513, Standard Specification for Steel Tapping Screws for Cold-Formed Steel Framing Connections.
- ASTM C645, Standard Specification for Nonstructural Steel Framing Members.

### DESCRIPTION

**Z Furrings** are fabricated in 1", 1-1/4", 1-1/2", 2", 2-1/2", 3-1/2", 4", 6", 8", 10", 12", 14" and 16" widths from 25 gauge to 10 gauge steel. The flange sizes are 1", 1-1/4", 1-1/2", 2", 2-1/2", 3", 3-1/2". Standard length 10' and special lengths are available.

### RECOGNITION

For Tables of Z- Member Section Properties (18 mil – 118 mil studs, structural 25 ga – 10 ga) refer to **Steeler ICC-ES Report ESR-2054**, pages 22-23.

### MATERIALS

**Z Furring** section is fabricated from **25 to 10 gauge** hot dipped galvanized steel conforming to ASTM A653 or equal.

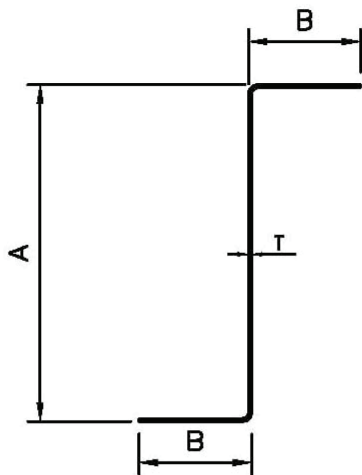

Z-Members without Lips

( Z FURRING)

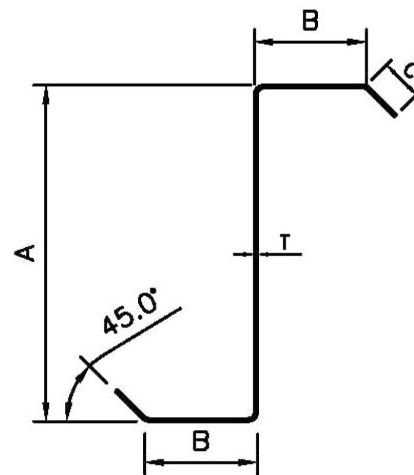

Z-Members with Lips

(Z PURLIN)