

# SMOOTH PRODUCTS INC.

## D·R·Y·W·A·L·L F·R·A·M·I·N·G

TACOMA, WA

PATENT PENDING

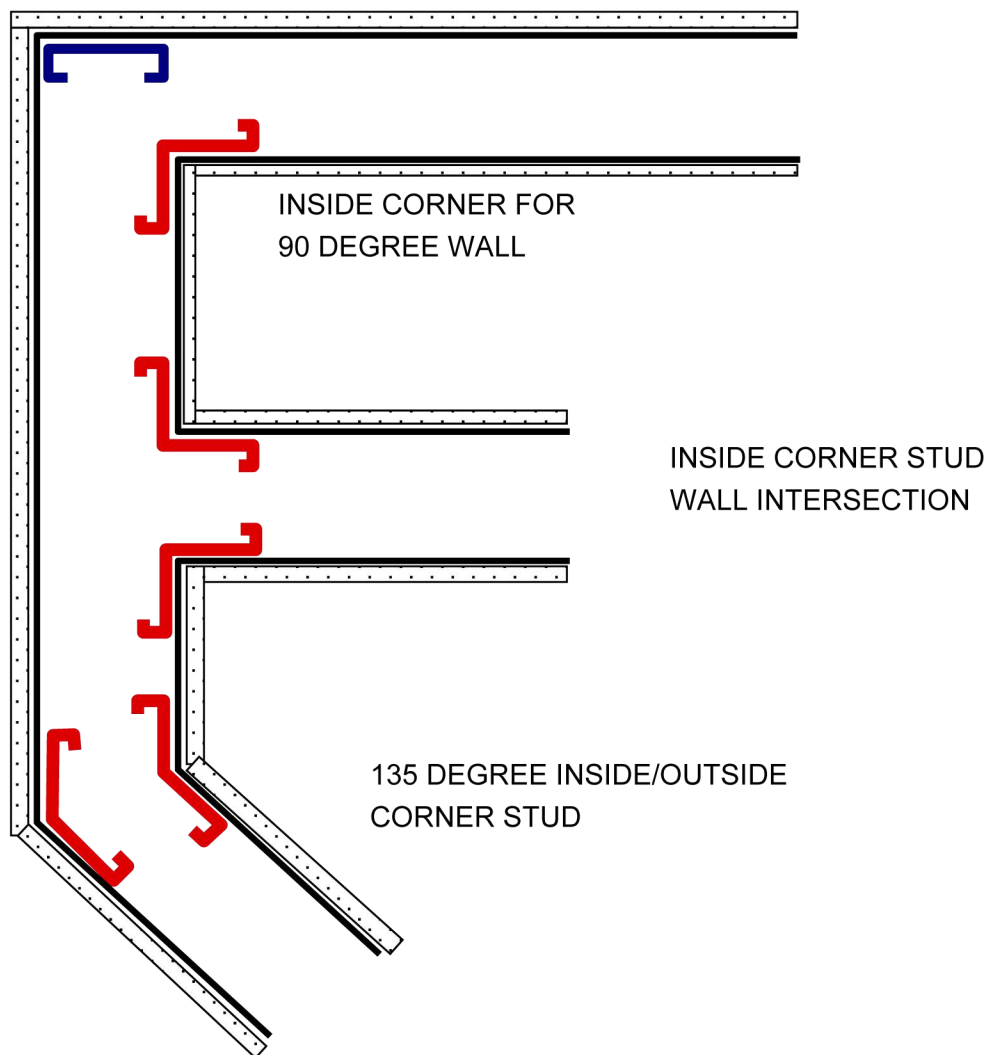

**STEELER, INC. IS EXCLUSIVE DISTRIBUTOR OF  
SMOOTH PRODUCTS**

Toll Free 877-269-8080

Fax 206-725-1700

**SEATTLE**  
206-725-8500

**SPOKANE**  
509-926-7403

**LAS VEGAS**  
702-251-4640

**SACRAMENTO**  
916-483-3600

**TACOMA**  
253-572-8200

**DELTA, B.C.**  
604-940-1332

**TUCSON**  
520-690-0077

**NEWARK**  
510-505-9595

**PORTLAND**  
503-231-1100

**CORPORATE**  
1-800-275-2279

**BAKERSFIELD**  
661-399-3333

**SAN DIEGO**  
619-527-1000

# SMOOTH PRODUCTS INC.

## D·R·Y·W·A·L·L F·R·A·M·I·N·G

TACOMA, WA

10023 Martin Luther King Jr. Way South Seattle, WA 98178 P. 877-269-8080 F. 206-725-1700

Smooth Products Patent Pending

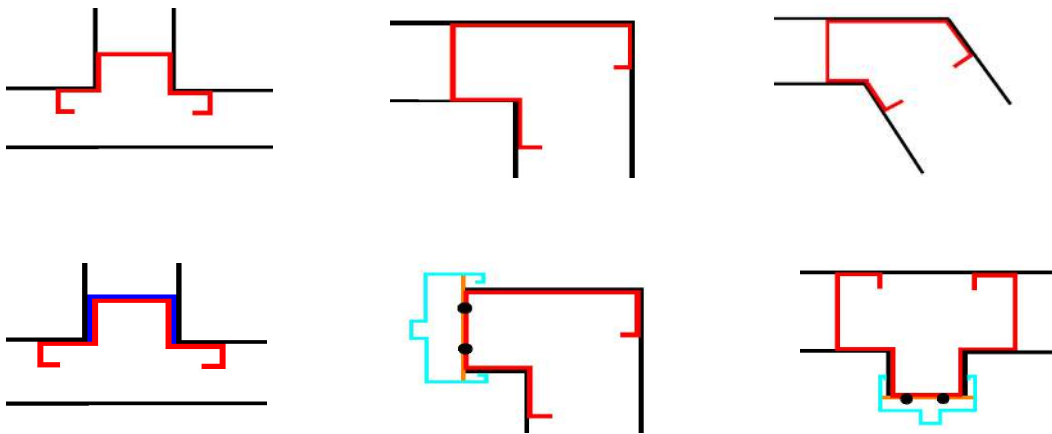

T Stud for Wall Intersection

Corner Stud

45 Stud Wall

T Stud for 1 and 2 Hour Wall

Corner Stud Door

T Door Stud

# SMOOTH PRODUCTS INC. D·R·Y·W·A·L·L F·R·A·M·I·N·G

TACOMA, WA

## ONE SIZE FITS ALL

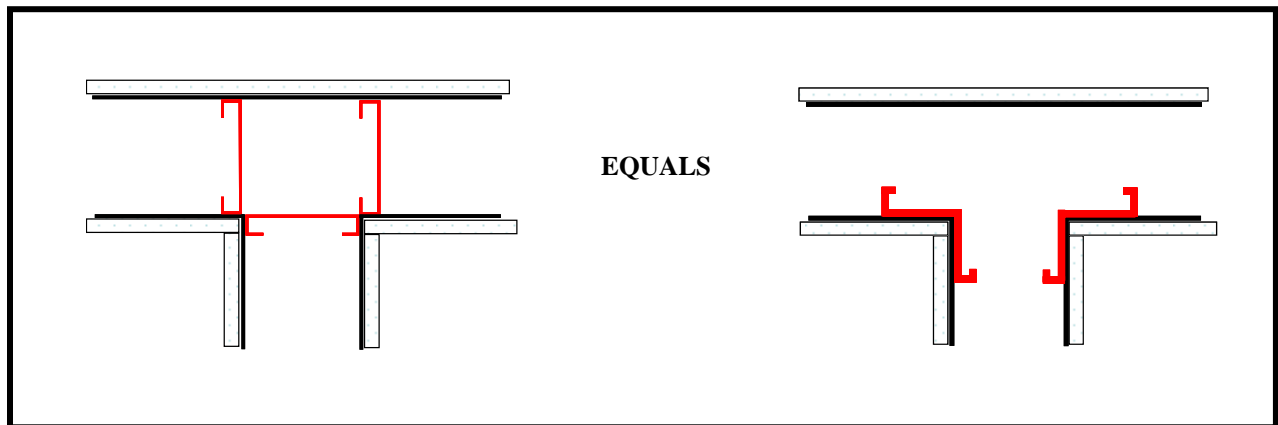
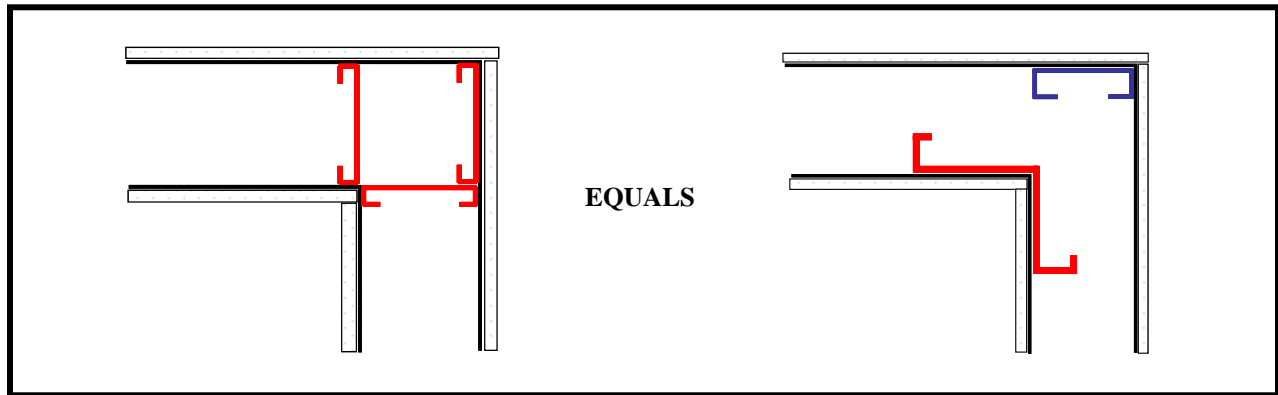

**THE NEW INSIDE CORNER STUDS\***

\*PATENT PENDING

# SMOOTH PRODUCTS INC. D·R·Y·W·A·L·L F·R·A·M·I·N·G

TACOMA, WA

## INSIDE CORNER STUD

90 DEGREE

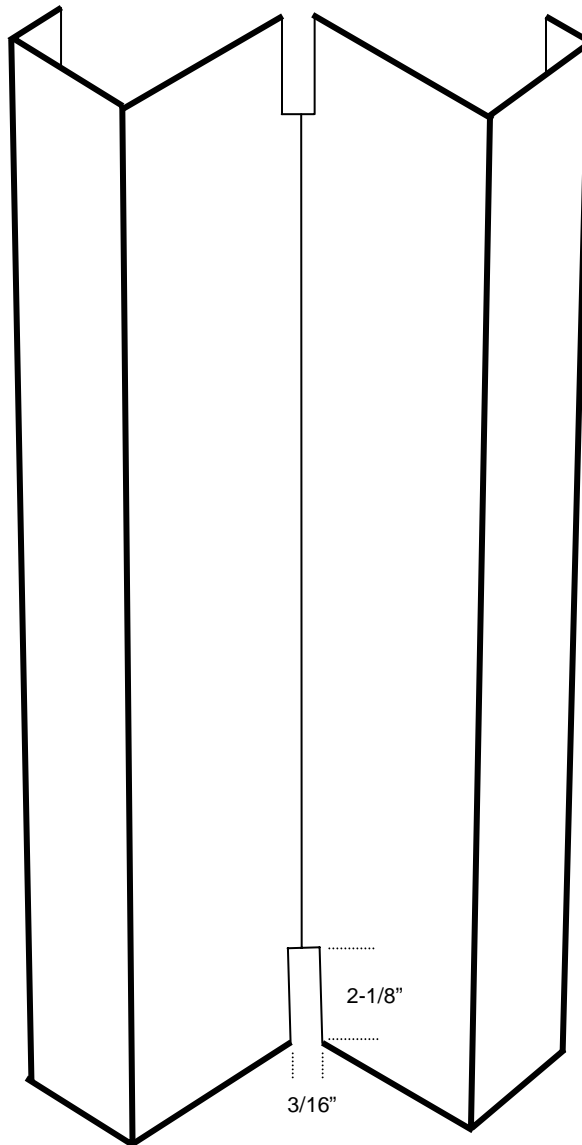

GAUGE	(mil)
22	0.027
21	0.030
20	0.033
18	0.043
16	0.054

# SMOOTH PRODUCTS INC

## D·R·Y·W·A·L·L F·R·A·M·I·N·G

TACOMA, WA

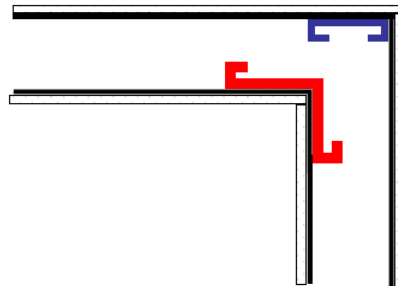

### Smooth Product Patent Pending Inside Corner Studs for 90° Angle Wall

400ICS-90-22 GA\*

- Great for use in smaller rooms
  - Smarter, faster, better for tenant improvements
  - Provides solid corners for the tapers
  - Saves time and money for the contractor and owner
  - No need for back screwing studs
  - Avoid having to handle sharp edges
  - No need to find the slider stud
- Ideal for hospital and tenant improvements or remodels

\* Smooth Products will create 20,21,22 Gauges

Patent Pending

# SMOOTH PRODUCTS INC.

## D·R·Y·W·A·L·L F·R·A·M·I·N·G

TACOMA, WA

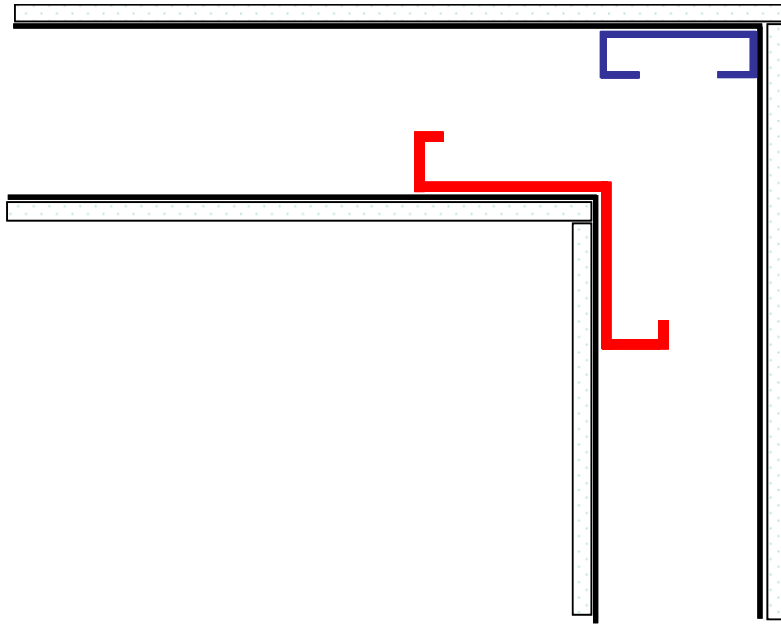

**INSIDE CORNER STUD FOR 90° ANGLE**

**PATENT PENDING**

# SMOOTH PRODUCTS INC

## D·R·Y·W·A·L·L F·R·A·M·I·N·G

TACOMA, WA

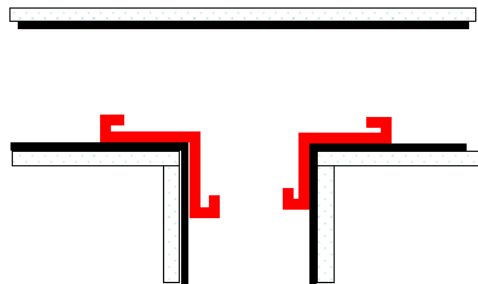

### Smooth Product Patent Pending

## Inside Corner Studs for Wall Intersection

400ICS-90-22 GA\*

- Great for use in smaller rooms
  - Smarter, faster, better for tenant improvements
  - Provides solid corners for the tapers
  - Saves time and money for the contractor and owner
  - No need for back screwing studs
  - Avoid having to handle sharp edges
  - No need to find the slider stud
- Ideal for hospital and tenant improvements or remodels

# SMOOTH PRODUCTS INC.

## D·R·Y·W·A·L·L F·R·A·M·I·N·G

TACOMA, WA

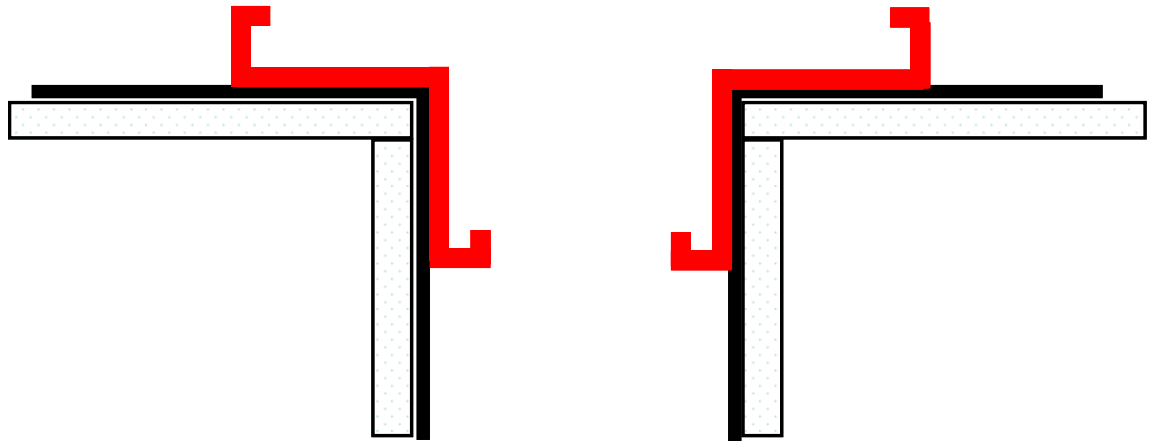

**INSIDE CORNER STUD FOR WALL INTERSECTION**

**PATENT PENDING**



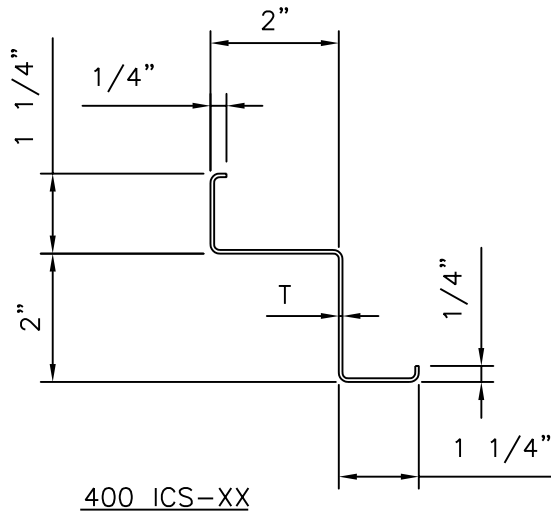

400 ICS-XX  
Inside Corner Stud (ICS)

GROSS PROPERTY TABLES—SMOOTH PRODUCTS (ICS) Inside Corner Studs								
MEMBER ID	GA	T, in	A, in <sup>2</sup>	WT, plf	I <sub>x</sub> , in <sup>4</sup>	r <sub>x</sub> , in	I <sub>y</sub> , in <sup>4</sup>	r <sub>y</sub> , in
400 ICS-27	(22)	0.0283	0.1884	0.641	0.1897	1.003	0.190	1.003
400 ICS-30	(21)	0.0312	0.2073	0.705	0.2078	1.001	0.208	1.001
400 ICS-33	(20)	0.0346	0.2293	0.779	0.2288	0.999	0.229	0.999
400 ICS-43	(18)	0.0451	0.2965	1.008	0.2916	0.992	0.292	0.992
400 ICS-54	(16)	0.0566	0.366	1.246	0.353	0.982	0.353	0.982

EFFECTIVE PROPERTY TABLES				
MEMBER Identification	FY=33 KSI			
	Maxo k-in	I <sub>xe</sub> in <sup>4</sup>	S <sub>xe(t)</sub> in <sup>3</sup>	S <sub>xe(b)</sub> in <sup>3</sup>
400 ICS-27	1.8012	0.1687	0.0912	0.1230
400 ICS-30	2.0507	0.1901	0.1038	0.1370
400 ICS-33	2.3574	0.2160	0.1193	0.1538
400 ICS-43	3.9347	0.2759	0.1531	0.1966
400 ICS-54	5.1342	0.3400	0.1905	0.2412

LIMITING HEIGHT TABLE			
MEMBER Identification	5 PSF, L/120, FY=33 KSI		
	MEMBER HEIGHT, ft		
	12"OC	16"OC	24"OD
400 ICS-27	15.50	13.42	10.96
400 ICS-30	16.54	14.32	11.69
400 ICS-33	17.73	15.35	12.54
400 ICS-43	19.34	17.57	15.35
400 ICS-54	20.73	18.84	16.46



EXPIRES: 07/27/2007

SMOOTH PRODUCTS INC. ---- (ICS) Inside Corner Stud	DATE: 2-6-07
DRYWALL PRODUCTS, TACOMA, WASHINGTON	DRAWING: SP-1

# SMOOTH PRODUCTS INC.

## D·R·Y·W·A·L·L F·R·A·M·I·N·G

TACOMA, WA

1970

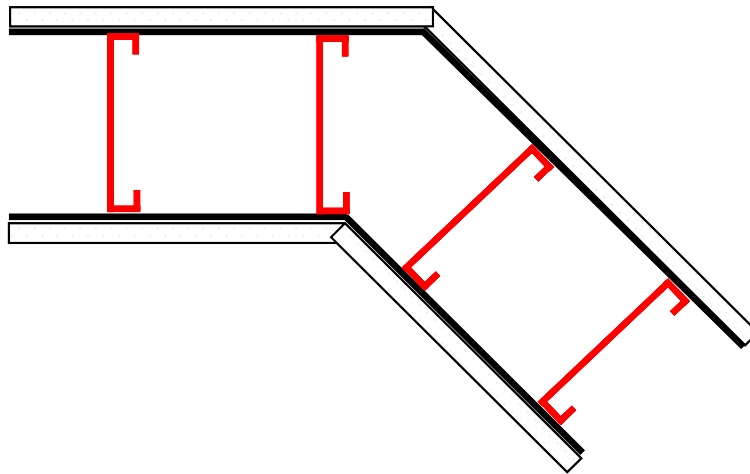

400 OCS 135-22G  
400 OCS 135-21G  
400 OCS 135-20G

2006

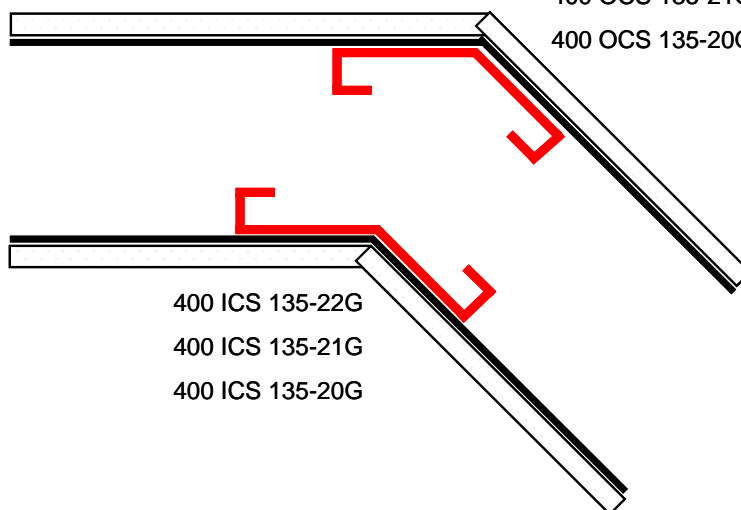

400 ICS 135-22G  
400 ICS 135-21G  
400 ICS 135-20G

**THE NEW INSIDE/OUTSIDE 135 CORNER STUDS\***

\*PATENT PENDING

# SMOOTH PRODUCTS D·R·Y·W·A·L·L F·R·A·M·I·N·G

TACOMA, WA

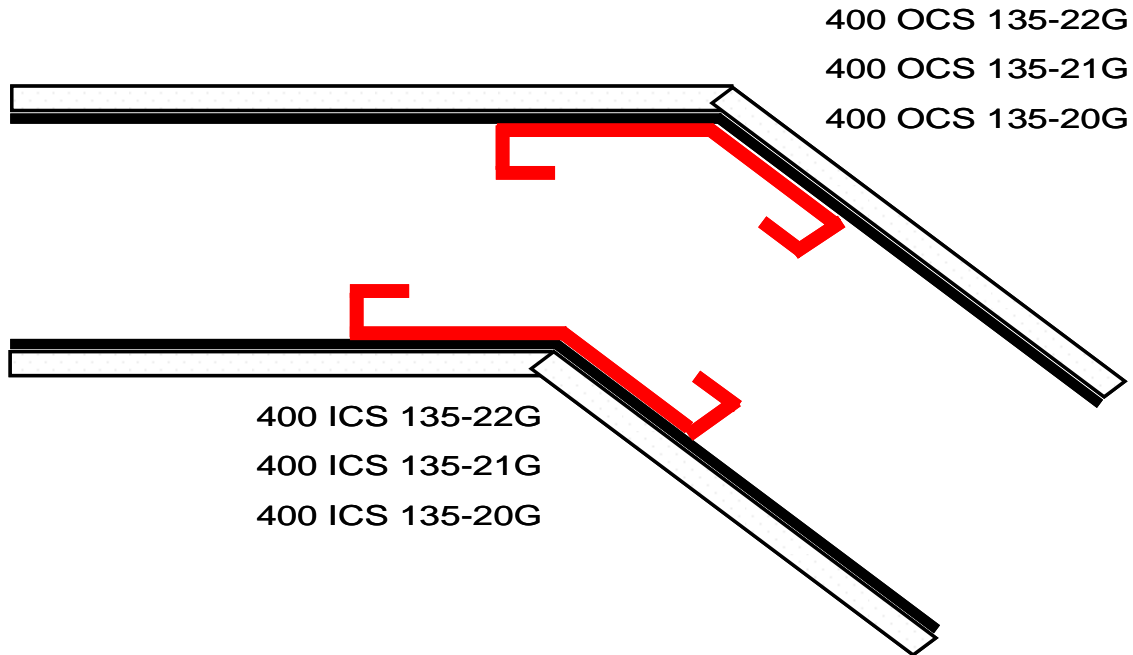

## THE NEW INSIDE/OUTSIDE 135 CORNER STUDS

PATENT PENDING

### Features and Benefits

Smooth Products will adjust angle to customer specifications (90-180°)

- Great for using in small rooms
- Smarter, faster, better for tenant improvement
- Solid outside/inside corners for the tapers
- Easier to install taping trims
- Save time and money for contractors and owners
- No screwing studs together to make angles
- Save time by not having to measure angles
- No handling sharp edges

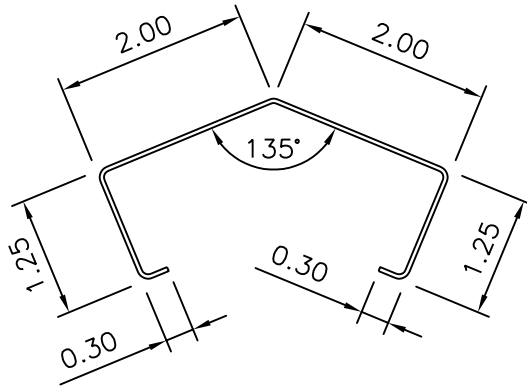

400 OCS 135-XX

OUTSIDE CORNER (OCS) 135° STUD

GROSS PROPERTY TABLES--OUTSIDE 135° CORNER STUDS

MEMBER ID	GA	T, in	A, in <sup>2</sup>	WT, plf	I <sub>x</sub> , in <sup>4</sup>	r <sub>x</sub> , in	I <sub>y</sub> , in <sup>4</sup>	r <sub>y</sub> , in
400 OCS 135-27	(22)	0.0283	0.1927	0.6553	0.0658	0.5841	0.3148	1.2781
400 OCS 135-30	(21)	0.0312	0.2121	0.7211	0.0720	0.5828	0.3457	1.2768
400 OCS 135-33	(20)	0.0346	0.2347	0.7979	0.0793	0.5813	0.3817	1.2753
400 OCS 135-43	(18)	0.0451	0.3038	1.0329	0.1011	0.5767	0.4906	1.2708
400 OCS 135-54	(16)	0.0566	0.3764	1.2799	0.1225	0.5705	0.6012	1.2637

EFFECTIVE PROPERTY TABLES

MEMBER IDentification	FY=33 KSI			
	Maxo k-in	I <sub>xe</sub> in <sup>4</sup>	S <sub>xe(t)</sub> in <sup>3</sup>	S <sub>xe(b)</sub> in <sup>3</sup>
400 OCS 135-27	1.2120	0.06321	0.07458	0.06133
400 OCS 135-30	1.3488	0.07189	0.08721	0.06830
400 OCS 135-33	1.4865	0.07931	0.09640	0.07522
400 OCS 135-43	1.8953	0.10105	0.12302	0.09591
400 OCS 135-54	2.3072	0.12250	0.15014	0.11676

LIMITING HEIGHT TABLE

MEMBER IDentification	5 PSF, L/120, FY=33 KSI		
	MEMBER HEIGHT, ft		
	12"OC	16"OC	24"OD
400 OCS 135-27	11.83	10.75	9.39
400 OCS 135-30	12.35	11.22	9.80
400 OCS 135-33	12.76	11.60	10.13
400 OCS 135-43	13.84	12.57	10.88
400 OCS 135-54	14.75	13.41	11.71



EXPIRES: 07/27/2007

SMOOTH PRODUCTS INC.--OUTSIDE 135° CORNER STUDS

DATE: 2-6-07

DRYWALL PRODUCTS, TACOMA, WASHINGTON

DRAWING: SP-3

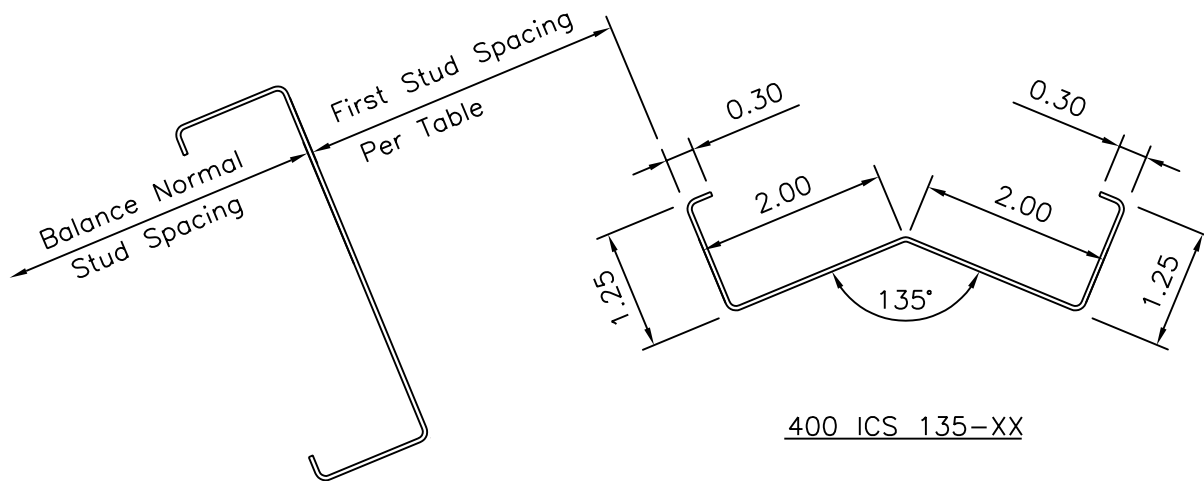

400 ICS 135-XX

INSIDE CORNER (ICS) 135° STUD

GROSS PROPERTY TABLES--INSIDE 135° CORNER STUDS

MEMBER ID	GA	T, in	A, in <sup>2</sup>	WT, plf	I <sub>x</sub> , in <sup>4</sup>	r <sub>x</sub> , in	I <sub>y</sub> , in <sup>4</sup>	r <sub>y</sub> , in
400 ICS 135-27	(22)	0.0283	0.1927	0.6553	0.02066	0.3274	0.4766	1.5726
400 ICS 135-30	(21)	0.0312	0.2121	0.7211	0.02260	0.3264	0.5290	1.5702
400 ICS 135-33	(20)	0.0346	0.2347	0.7979	0.02484	0.3253	0.5766	1.5676
400 ICS 135-43	(18)	0.0451	0.3038	1.0329	0.03147	0.3218	0.7386	1.5592
400 ICS 135-54	(16)	0.0566	0.3764	1.2799	0.03764	0.3162	0.9010	1.5471

EFFECTIVE PROPERTY TABLES

MEMBER Identification	FY=33 KSI			
	Maxo k-in	I <sub>xe</sub> in <sup>4</sup>	S <sub>xe(t)</sub> in <sup>3</sup>	S <sub>xe(b)</sub> in <sup>3</sup>
400 ICS 135-27	0.5497	0.02066	0.02782	0.04184
400 ICS 135-30	0.6019	0.02260	0.03046	0.04574
400 ICS 135-33	0.6621	0.02484	0.03351	0.05023
400 ICS 135-43	0.8419	0.03147	0.04261	0.06352
400 ICS 135-54	1.0106	0.03764	0.05114	0.07678

LIMITING HEIGHT TABLE, 5 psf, F<sub>y</sub>=33 ksi

MEMBER Identification	Member Height, ft		
	First Stud Spacing, in.		
	6"	8"	10"
400 ICS 135-27	12.11	10.49	9.38
400 ICS 135-30	12.67	10.97	9.81
400 ICS 135-33	13.29	11.51	10.29
400 ICS 135-43	14.98	12.98	11.61
400 ICS 135-54	16.42	14.22	12.72

NOTE:  
HEIGHT TABLE BASE ON STRENGTH W/O STRESS INCREASE



EXPIRES: 07/27/2007

SMOOTH PRODUCTS INC.--INSIDE 135° CORNER STUDS

DATE: 2-13-07

DRYWALL PRODUCTS, TACOMA, WASHINGTON

DRAWING: SP-2

# SMOOTH PRODUCTS D·R·Y·W·A·L·L F·R·A·M·I·N·G

TACOMA, WA

## TURNING A CORNER HAS NEVER BEEN EASIER

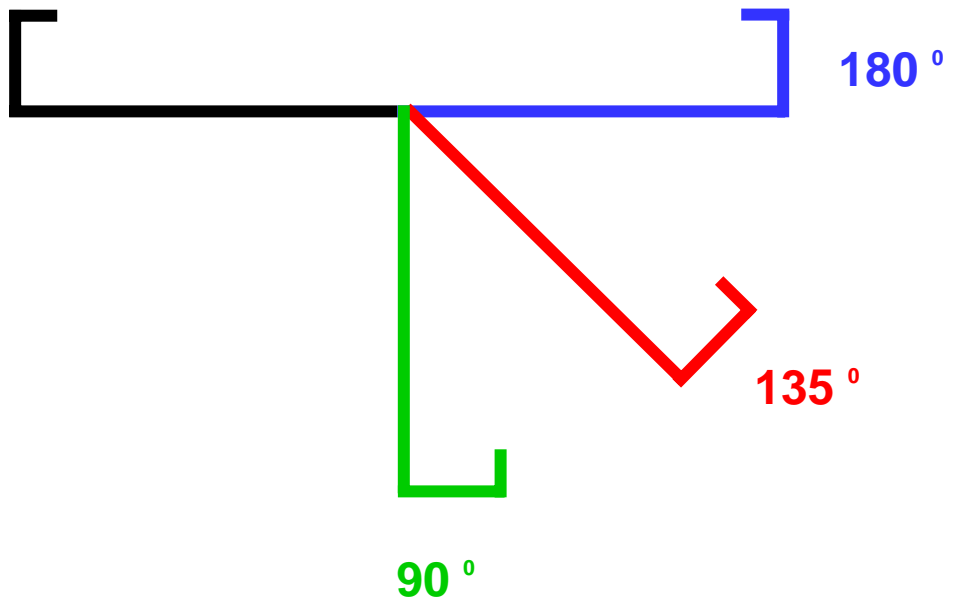

PERFECT CORNERS EVERYTIME

# SMOOTH PRODUCTS INC.

## D·R·Y·W·A·L·L F·R·A·M·I·N·G

TACOMA, WA

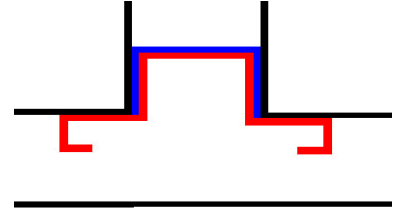
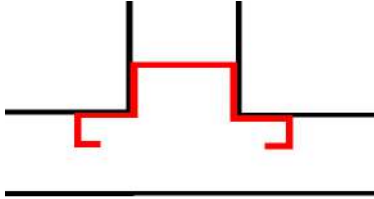

### The T Stud For Wall Intersection

0250 T Stud	0250-T-S-22	GA*
0362 T Stud	0362-T-S-22	
0400 T Stud	0400-T-S-22	
0600 T Stud	0600-T-S-22	

### The T Stud For 1 & 2 Hr Wall

0362 T Stud 1HR/2HR	0362-T-S-1HR-22	GA*
0400 T Stud 1HR/2HR	0400-T-S-1HR-22	
0600 T Stud 1HR/2HR	0600-T-S-1HR-22	

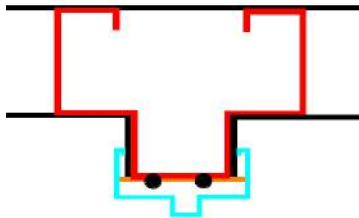

### The T Door Stud

0362 T Stud Door	0362-T-S-D-22	GA*
0400 T Stud Door	0400-T-S-D-22	
0600 T Stud Door	0600-T-S-D-22	

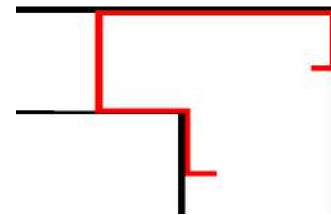

### The Corner Stud

0250 Corner Stud	0250-C-S-22	GA*
0362 Corner Stud	0362-C-S-22	
0400 Corner Stud	0400-C-S-22	
0600 Corner Stud	0600-C-S-22	

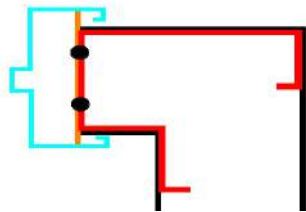

### The Corner Stud Door

0362 Corner Stud Door	0362-C-S-D-22	GA*
0400 Corner Stud Door	0400-C-S-D-22	
0600 Corner Stud Door	0600-C-S-D-22	

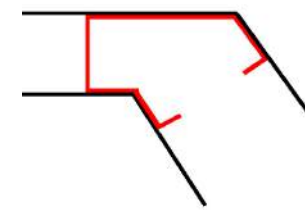

### The 45 Stud Wall

0250 45 STUD	0250-45-S-22	GA*
0362 45 STUD	0362-45-S-22	
0400 45 STUD	0400-45-S-22	
0600 45 STUD	0600-45-S-22	

ALL PUNCHOUTS ARE NOMINAL 2'-0" O.C. AND NO CLOSER THAT 10" FROM THE END OF MEMBER TO THE CLOSEST EDGE

# SMOOTH PRODUCTS INC.

## D·R·Y·W·A·L·L F·R·A·M·I·N·G

TACOMA, WA

TABLE 1-03 PHYSICAL PROPERTY TABLES - SMOOTH PRODUCTS STUDS

Member Designation	GA	Design Thick. in	Gross Properties						Effective, Fy=33 ksi				Effective, Fy=50 ksi			
			Area in <sup>2</sup>	Weight lb/ft	Ix in <sup>4</sup>	rx in	Iy in <sup>4</sup>	ry in	Maxo k-in	Ixe in <sup>4</sup>	Sxe(t) in <sup>3</sup>	Sxe(b) in <sup>3</sup>	Maxo k-in	Ixe in <sup>4</sup>	Sxe(t) in <sup>3</sup>	Sxe(b) in <sup>3</sup>
250 -T-S-27	(22)	0.0283	0.395	1.342	1.838	2.158	0.469	1.090	10.164	1.719	0.514	0.554	13.878	1.608	0.464	0.540
250 -T-S-30	(21)	0.0312	0.435	1.478	2.017	2.155	0.514	1.088	11.612	1.934	0.588	0.615	16.047	1.824	0.536	0.601
250 -T-S-33	(20)	0.0346	0.481	1.635	2.225	2.151	0.567	1.086	13.282	2.183	0.672	0.686	18.316	2.053	0.612	0.668
250 -T-S-43	(18)	0.0451	0.623	2.119	2.853	2.140	0.726	1.079	19.441	2.845	0.888	0.888	25.537	2.773	0.853	0.878
250 -T-S-54	(16)	0.0566	0.773	2.628	3.493	2.126	0.887	1.071	24.431	3.484	1.091	1.091	36.010	3.459	1.079	1.088
362 -T-S-27	(22)	0.0283	0.427	1.451	2.819	2.570	0.545	1.130	13.067	2.618	0.661	0.725	17.712	2.441	0.592	0.709
362 -T-S-30	(21)	0.0312	0.470	1.597	3.095	2.567	0.598	1.128	15.034	2.956	0.761	0.804	20.563	2.775	0.687	0.788
362 -T-S-33	(20)	0.0346	0.520	1.768	3.416	2.563	0.659	1.126	17.260	3.341	0.873	0.896	23.580	3.133	0.788	0.876
362 -T-S-43	(18)	0.0451	0.674	2.291	4.389	2.552	0.844	1.119	25.436	4.376	1.162	1.162	33.290	4.257	1.112	1.149
362 -T-S-54	(16)	0.0566	0.837	2.845	5.388	2.538	1.032	1.111	32.029	5.372	1.430	1.430	47.227	5.336	1.415	1.426
400 -T-S-27	(22)	0.0283	0.437	1.487	3.204	2.707	0.568	1.139	14.057	2.968	0.711	0.787	19.023	2.765	0.635	0.770
400 -T-S-30	(21)	0.0312	0.481	1.637	3.519	2.704	0.623	1.138	16.191	3.354	0.819	0.872	22.104	3.146	0.738	0.855
400 -T-S-33	(20)	0.0346	0.533	1.812	3.885	2.700	0.687	1.135	18.634	3.796	0.943	0.972	25.377	3.554	0.848	0.951
400 -T-S-43	(18)	0.0451	0.691	2.349	4.994	2.689	0.880	1.128	24.883	4.981	1.259	1.260	35.974	4.840	1.202	1.247
400 -T-S-54	(16)	0.0566	0.858	2.917	6.136	2.674	1.076	1.120	34.750	6.120	1.552	1.552	48.255	6.120	1.552	1.552
600 -T-S-27	(22)	0.0283	0.494	1.679	5.800	3.427	0.673	1.167	20.251	5.356	1.025	1.135	20.251	5.356	1.025	1.135
600 -T-S-30	(21)	0.0312	0.544	1.849	6.373	3.424	0.738	1.165	23.471	6.073	1.188	1.259	31.312	5.635	1.046	1.239
600 -T-S-33	(20)	0.0346	0.602	2.047	7.041	3.420	0.814	1.163	26.985	6.875	1.366	1.404	36.544	6.419	1.221	1.374
600 -T-S-43	(18)	0.0451	0.781	2.655	9.072	3.408	1.043	1.156	40.033	9.059	1.828	1.828	52.399	8.810	1.750	1.807
600 -T-S-54	(16)	0.0566	0.971	3.302	11.176	3.392	1.278	1.147	50.554	11.161	2.258	2.258	74.617	11.091	2.236	2.252
362 -T-S-2HR-27	(22)	0.0283	0.427	1.451	2.590	2.464	0.445	1.021	11.388	2.315	0.576	0.652	15.589	2.161	0.521	0.632
362 -T-S-2HR-30	(21)	0.0312	0.470	1.597	2.844	2.461	0.488	1.019	13.028	2.613	0.659	0.726	18.026	2.456	0.602	0.705
362 -T-S-2HR-33	(20)	0.0346	0.520	1.768	3.139	2.457	0.538	1.017	14.972	2.961	0.758	0.812	20.517	2.765	0.685	0.785
362 -T-S-2HR-43	(18)	0.0451	0.674	2.291	4.030	2.446	0.688	1.011	20.526	3.957	1.039	1.062	28.846	3.767	0.963	1.039
362 -T-S-2HR-54	(16)	0.0566	0.837	2.845	4.947	2.431	0.840	1.002	29.479	4.945	1.317	1.317	38.595	4.881	1.289	1.310
400 -T-S-2HR-27	(22)	0.0283	0.437	1.487	2.946	2.596	0.474	1.041	12.333	2.632	0.624	0.706	16.853	2.455	0.563	0.685
400 -T-S-2HR-30	(21)	0.0312	0.481	1.637	3.235	2.592	0.520	1.040	14.102	2.969	0.714	0.786	19.489	2.790	0.651	0.764
400 -T-S-2HR-33	(20)	0.0346	0.533	1.812	3.571	2.589	0.573	1.037	16.198	3.364	0.820	0.879	22.236	3.145	0.743	0.851
400 -T-S-2HR-43	(18)	0.0451	0.691	2.349	4.588	2.577	0.734	1.031	22.204	4.497	1.124	1.151	31.231	4.284	1.043	1.126
400 -T-S-2HR-54	(16)	0.0566	0.858	2.917	5.635	2.563	0.897	1.022	31.987	5.633	1.429	1.429	41.775	5.551	1.395	1.420
600 -T-S-2HR-27	(22)	0.0283	0.494	1.679	5.380	3.301	0.609	1.110	17.781	4.778	0.900	1.031	23.876	4.424	0.798	1.006
600 -T-S-2HR-30	(21)	0.0312	0.544	1.849	5.912	3.297	0.668	1.109	20.446	5.406	1.035	1.147	28.075	5.067	0.938	1.118
600 -T-S-2HR-33	(20)	0.0346	0.602	2.047	6.531	3.294	0.737	1.106	23.477	6.122	1.188	1.281	32.134	5.724	1.073	1.245
600 -T-S-2HR-43	(18)	0.0451	0.781	2.655	8.412	3.282	0.944	1.100	32.170	8.191	1.628	1.679	45.417	7.824	1.517	1.646
600 -T-S-2HR-54	(16)	0.0566	0.971	3.302	10.362	3.267	1.157	1.091	43.467	10.346	2.093	2.093	60.666	10.141	2.026	2.077
362 -T-S-D-27*	(22)	0.0283	0.731	2.485	10.129	3.723	3.271	2.116	17.618	5.548	0.892	1.207	23.423	5.017	0.774	1.157
362 -T-S-D-30*	(21)	0.0312	0.805	2.737	11.138	3.720	3.596	2.114	20.240	6.289	1.024	1.346	26.865	5.724	0.897	1.291
362 -T-S-D-33*	(20)	0.0346	0.892	3.032	12.315	3.716	3.976	2.111	23.446	7.182	1.187	1.511	31.526	6.591	1.053	1.450
362 -T-S-D-43*	(18)	0.0451	1.159	3.940	15.903	3.705	5.131	2.104	34.379	10.113	1.740	2.034	46.614	9.354	1.557	1.958
362 -T-S-D-54*	(16)	0.0566	1.445	4.914	19.693	3.691	6.345	2.095	47.617	13.499	2.410	2.616	65.624	12.642	2.192	2.532
400 -T-S-D-27*	(22)	0.0283	0.763	2.593	11.715	3.919	3.821	2.238	18.915	6.289	0.957	1.360	25.111	5.707	0.839	1.301
400 -T-S-D-30*	(21)	0.0312	0.840	2.857	12.884	3.916	4.201	2.236	21.962	7.173	1.111	1.515	28.853	6.490	0.964	1.457
400 -T-S-D-33*	(20)	0.0346	0.931	3.165	14.247	3.912	4.645	2.234	25.515	8.209	1.291	1.702	33.952	7.491	1.134	1.637
400 -T-S-D-43*	(18)	0.0451	1.210	4.112	18.406	3.901	5.998	2.227	37.615	11.613	1.904	2.295	50.891	10.722	1.700	2.210
400 -T-S-D-54*	(16)	0.0566	1.509	5.130	22.809	3.888	7.423	2.218	52.542	15.596	2.659	2.959	71.972	14.548	2.404	2.861
600 -T-S-D-27*	(22)	0.0283	0.933	3.171	22.709	4.935	7.911	2.913	25.792	10.990	1.305	2.303	33.406	9.803	1.116	2.224
600 -T-S-D-30*	(21)	0.0312	1.027	3.493	24.986	4.932	8.704	2.911	29.881	12.575	1.512	2.581	39.293	11.321	1.312	2.482
600 -T-S-D-33*	(20)	0.0346	1.138	3.871	27.646	4.928	9.629	2.908	35.379	14.580	1.790	2.895	46.733	13.188	1.561	2.787
600 -T-S-D-43*	(18)	0.0451	1.480	5.032	35.780	4.917	12.460	2.901	54.766	21.282	2.772	3.883	71.748	19.278	2.396	3.769
600 -T-S-D-54*	(16)	0.0566	1.849	6.285	44.450	4.904	15.460	2.892	77.912	29.001	3.943	5.016	105.820	26.868	3.534	4.854

**Notes:**

1. Members marked \* indicate h/t>200 or b/t>60
2. Member properties per 2004 AISI Specifications



EXPIRES: 07/27/2007



# SMOOTH PRODUCTS INC.

## D·R·Y·W·A·L·L F·R·A·M·I·N·G

TACOMA, WA

TABLE 1-03 PHYSICAL PROPERTY TABLES - SMOOTH PRODUCTS STUDS

Member Designation	GA	Design Thick. in	Gross Properties						Effective, Fy=33 ksi				Effective, Fy=50 ksi			
			Area in <sup>2</sup>	Weight lb/ft	Ix in <sup>4</sup>	rx in	Iy in <sup>4</sup>	ry in	Maxo k-in	Ixe in <sup>4</sup>	Sxe(t) in <sup>3</sup>	Sxe(b) in <sup>3</sup>	Maxo k-in	Ixe in <sup>4</sup>	Sxe(t) in <sup>3</sup>	Sxe(b) in <sup>3</sup>
250 -C-S-27	(22)	0.0283	0.356	1.211	0.587	1.284	0.871	1.564	3.677	0.430	0.259	0.186	5.328	0.392	0.222	0.178
250 -C-S-30	(21)	0.0312	0.392	1.334	0.645	1.282	0.958	1.563	4.114	0.489	0.302	0.208	5.982	0.450	0.263	0.200
250 -C-S-33	(20)	0.0346	0.434	1.477	0.711	1.280	1.059	1.561	4.626	0.559	0.354	0.234	6.754	0.520	0.313	0.226
250 -C-S-43	(18)	0.0451	0.563	1.915	0.913	1.273	1.366	1.558	6.230	0.783	0.533	0.315	9.115	0.732	0.472	0.304
250 -C-S-54	(16)	0.0566	0.700	2.380	1.120	1.265	1.686	1.552	7.949	1.036	0.758	0.402	11.676	0.973	0.672	0.390
362 -C-S-27	(22)	0.0283	0.420	1.428	1.236	1.715	1.644	1.979	5.855	0.842	0.373	0.296	8.488	0.761	0.315	0.284
362 -C-S-30	(21)	0.0312	0.462	1.572	1.358	1.714	1.808	1.978	6.559	0.967	0.443	0.332	9.537	0.878	0.376	0.319
362 -C-S-33	(20)	0.0346	0.512	1.741	1.500	1.711	2.000	1.976	7.374	1.110	0.524	0.373	10.772	1.019	0.451	0.360
362 -C-S-43	(18)	0.0451	0.665	2.260	1.931	1.705	2.586	1.972	9.908	1.569	0.804	0.501	14.552	1.460	0.703	0.486
362 -C-S-54	(16)	0.0566	0.827	2.813	2.380	1.696	3.200	1.967	12.642	2.083	1.149	0.640	18.616	1.955	1.016	0.622
400 -C-S-27*	(22)	0.0283	0.441	1.500	1.523	1.858	1.973	2.115	6.668	1.015	0.412	0.337	9.665	0.915	0.347	0.323
400 -C-S-30	(21)	0.0312	0.486	1.652	1.673	1.856	2.171	2.114	7.471	1.168	0.491	0.378	10.861	1.057	0.414	0.363
400 -C-S-33	(20)	0.0346	0.538	1.829	1.849	1.854	2.401	2.113	8.398	1.341	0.581	0.425	12.271	1.228	0.498	0.410
400 -C-S-43	(18)	0.0451	0.699	2.375	2.383	1.847	3.106	2.109	11.282	1.902	0.895	0.571	16.579	1.767	0.781	0.554
400 -C-S-54	(16)	0.0566	0.870	2.958	2.939	1.838	3.846	2.103	14.393	2.533	1.289	0.728	21.211	2.375	1.136	0.708
600 -C-S-27*	(22)	0.0283	0.554	1.885	3.751	2.601	4.431	2.827	11.611	2.304	0.649	0.588	16.112	2.059	0.538	0.565
600 -C-S-30*	(21)	0.0312	0.611	2.076	4.126	2.599	4.876	2.826	13.023	2.720	0.814	0.659	18.925	2.363	0.633	0.632
600 -C-S-33*	(20)	0.0346	0.676	2.300	4.562	2.597	5.397	2.825	14.656	3.170	0.993	0.742	21.381	2.779	0.778	0.714
600 -C-S-43	(18)	0.0451	0.879	2.988	5.895	2.590	6.991	2.820	19.579	4.402	1.461	0.991	28.927	4.159	1.320	0.966
600 -C-S-54	(16)	0.0566	1.096	3.727	7.297	2.580	8.679	2.814	24.981	5.841	2.069	1.264	36.889	5.501	1.847	1.232
362 -C-S-D-27*	(22)	0.0283	0.569	1.933	1.721	1.740	4.254	2.735	6.858	0.907	0.347	0.365	9.075	0.825	0.303	0.347
362 -C-S-D-30*	(21)	0.0312	0.626	2.129	1.892	1.738	4.681	2.734	8.039	1.041	0.407	0.411	10.644	0.949	0.356	0.391
362 -C-S-D-33*	(20)	0.0346	0.694	2.359	2.091	1.736	5.181	2.733	9.222	1.214	0.488	0.467	12.534	1.097	0.419	0.444
362 -C-S-D-43	(18)	0.0451	0.901	3.065	2.698	1.730	6.708	2.728	12.660	1.761	0.755	0.641	18.317	1.606	0.654	0.612
362 -C-S-D-54	(16)	0.0566	1.125	3.824	3.336	1.722	8.324	2.721	16.491	2.408	1.103	0.835	23.942	2.211	0.960	0.800
400 -C-S-D-27*	(22)	0.0283	0.590	2.005	2.118	1.895	4.837	2.864	7.656	1.105	0.387	0.422	10.120	1.004	0.338	0.401
400 -C-S-D-30*	(21)	0.0312	0.650	2.209	2.329	1.893	5.324	2.863	8.979	1.269	0.454	0.474	11.876	1.156	0.397	0.452
400 -C-S-D-33*	(20)	0.0346	0.720	2.447	2.574	1.891	5.892	2.861	10.598	1.469	0.538	0.536	13.981	1.335	0.467	0.513
400 -C-S-D-43	(18)	0.0451	0.935	3.180	3.324	1.885	7.632	2.857	14.539	2.137	0.838	0.736	21.060	1.943	0.722	0.703
400 -C-S-D-54	(16)	0.0566	1.167	3.968	4.114	1.878	9.474	2.849	18.925	2.933	1.232	0.958	27.510	2.685	1.065	0.919
600 -C-S-D-27*	(22)	0.0283	0.703	2.390	5.139	2.704	8.858	3.550	12.332	2.568	0.624	0.765	16.242	2.328	0.543	0.732
600 -C-S-D-30*	(21)	0.0312	0.774	2.633	5.655	2.702	9.751	3.548	14.475	2.952	0.733	0.858	14.475	2.952	0.733	0.858
600 -C-S-D-33*	(20)	0.0346	0.858	2.918	6.257	2.700	10.796	3.547	17.136	3.415	0.867	0.968	22.464	3.100	0.750	0.930
600 -C-S-D-43	(18)	0.0451	1.116	3.793	8.097	2.694	13.998	3.542	25.912	5.048	1.400	1.311	34.436	4.492	1.150	1.266
600 -C-S-D-54	(16)	0.0566	1.393	4.738	10.053	2.686	17.409	3.535	33.439	6.830	2.005	1.692	49.105	6.378	1.794	1.640
250 -45-S-27*	(22)	0.0283	0.317	1.077	0.418	1.148	0.592	1.368	3.622	0.354	0.224	0.183	5.215	0.311	0.181	0.174
250 -45-S-30*	(21)	0.0312	0.349	1.186	0.459	1.147	0.651	1.366	4.057	0.406	0.265	0.205	5.870	0.363	0.220	0.196
250 -45-S-33	(20)	0.0346	0.386	1.313	0.506	1.145	0.720	1.365	4.543	0.460	0.306	0.230	6.655	0.428	0.271	0.222
250 -45-S-43	(18)	0.0451	0.501	1.704	0.651	1.140	0.928	1.360	6.041	0.629	0.437	0.306	8.933	0.600	0.403	0.298
250 -45-S-54	(16)	0.0566	0.624	2.121	0.801	1.133	1.144	1.354	7.544	0.790	0.558	0.382	11.356	0.780	0.546	0.379
362 -45-S-27*	(22)	0.0283	0.377	1.282	0.910	1.553	1.037	1.658	5.703	0.698	0.315	0.289	7.907	0.626	0.264	0.270
362 -45-S-30	(21)	0.0312	0.415	1.411	1.000	1.552	1.140	1.657	6.393	0.962	0.380	0.324	9.279	0.721	0.313	0.310
362 -45-S-33	(20)	0.0346	0.460	1.563	1.105	1.550	1.261	1.656	7.205	0.944	0.463	0.365	10.434	0.846	0.382	0.348
362 -45-S-43	(18)	0.0451	0.597	2.030	1.425	1.545	1.628	1.652	9.652	1.342	0.715	0.488	13.809	1.262	0.639	0.461
362 -45-S-54	(16)	0.0566	0.744	2.530	1.760	1.538	2.015	1.646	12.225	1.737	0.963	0.619	18.180	1.670	0.898	0.607
400 -45-S-27*	(22)	0.0283	0.388	1.318	1.110	1.692	1.070	1.662	6.462	0.849	0.352	0.327	8.953	0.778	0.300	0.299
400 -45-S-30*	(21)	0.0312	0.427	1.451	1.220	1.691	1.177	1.660	7.243	0.985	0.424	0.367	10.350	0.895	0.355	0.346
400 -45-S-33*	(20)	0.0346	0.473	1.607	1.349	1.689	1.301	1.659	8.156	1.147	0.515	0.413	11.628	1.030	0.427	0.388
400 -45-S-43	(18)	0.0451	0.614	2.088	1.741	1.684	1.681	1.655	10.930	1.643	0.810	0.553	15.497	1.524	0.703	0.518
400 -45-S-54	(16)	0.0566	0.765	2.602	2.152	1.677	2.080	1.649	13.825	2.128	1.094	0.700	20.505	2.047	1.019	0.685
600 -45-S-27*	(22)	0.0283	0.444	1.510	2.639	2.438	1.220	1.658	10.750	2.011	0.576	0.544	14.556	1.821	0.486	0.474
600 -45-S-30*	(21)	0.0312	0.489	1.663	2.903	2.436	1.342	1.656	12.568	2.388	0.729	0.636	16.636	2.388	0.729	0.636
600 -45-S-33	(20)	0.0346	0.542	1.843	3.212	2.434	1.484	1.655	14.229	2.799	0.898	0.720	19.105	2.428	0.686	0.638
600 -45-S-43	(18)	0.0451	0.704	2.394	4.154	2.429	1.917	1.650	18.910	3.893	1.328	0.957	27.246	3.681	1.192	0.910
600 -45-S-54	(16)	0.0566	0.879	2.987	5.150	2.421	2.374	1.644	23.832	5.070	1.818	1.206	35.478	4.851	1.661	1.185

**Notes:**

- Members marked \* indicate h/t>200 or b/t>60
- Member properties per 2004 AISI Specifications



EXPIRES: 07/27/2007

# SMOOTH PRODUCTS INC. D·R·Y·W·A·L·L F·R·A·M·I·N·G

TACOMA, WA

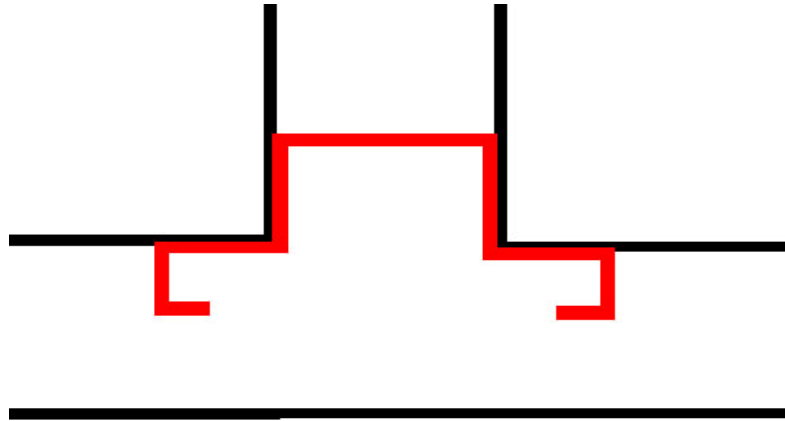

**Smooth Product Patent Pending**

## **The T Stud For Wall Intersection**

0250 T Stud	0250-T-S-22	GA*
0362 T Stud	0362-T-S-22	
0400 T Stud	0400-T-S-22	
0600 T Stud	0600-T-S-22	

- Great for use in smaller rooms
- Smarter, faster, better for tenant improvements
  - Provides solid corners for the tapers
- Saves time and money for the contractor and owner
- Punched holes for mechanical, electrical and plumbing trades
  - No need for back screwing studs
  - Avoid having to handle sharp edges
    - Use one stud instead of three
    - No need to find the slider stud

Ideal for hospital and tenant improvements or remodels

# SMOOTH PRODUCTS INC. D·R·Y·W·A·L·L F·R·A·M·I·N·G

TACOMA, WA

THREE STUDS

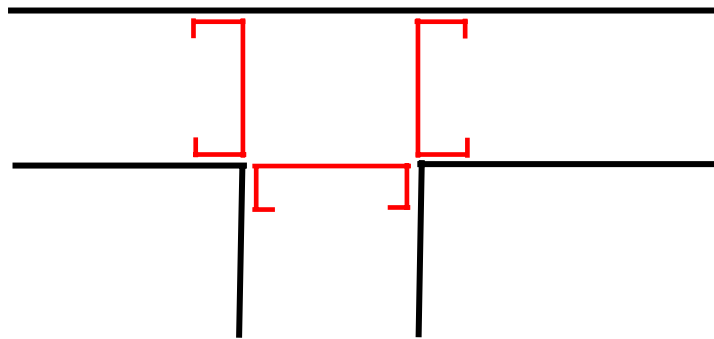

OR

ONE

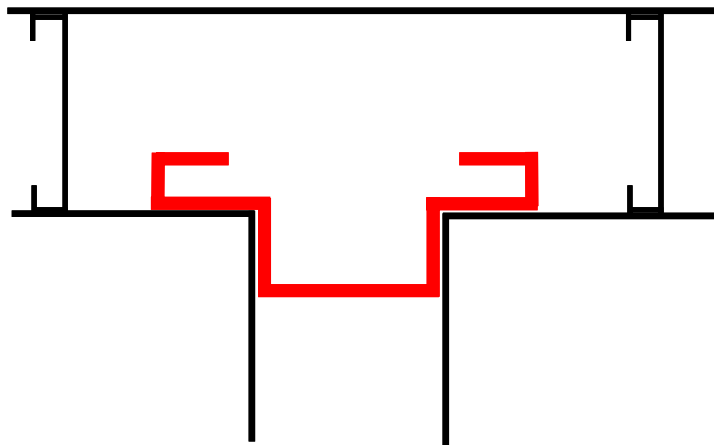

YOU DO THE MATH

THE NEW "T" STUD

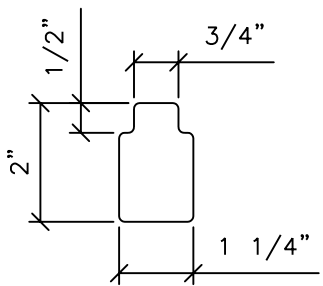
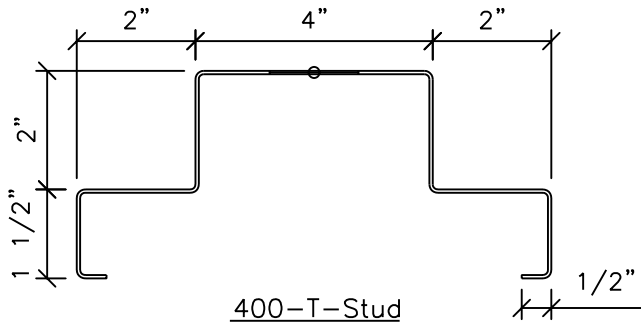
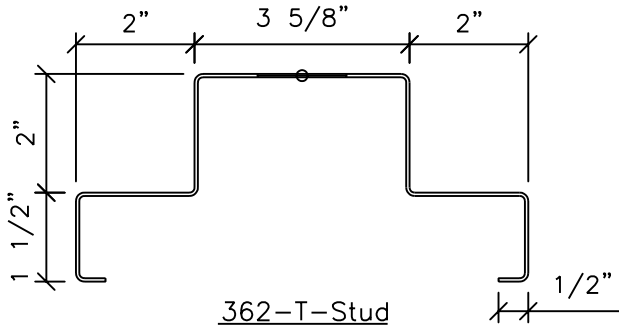
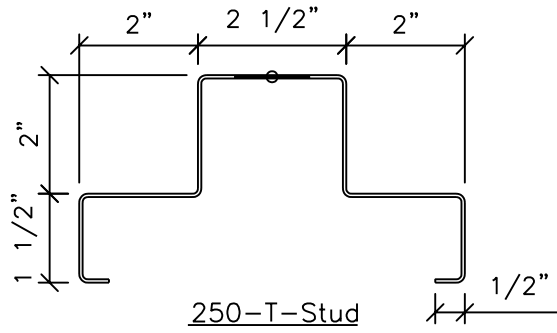

PUNCHOUTS @ 24 INCHES OC

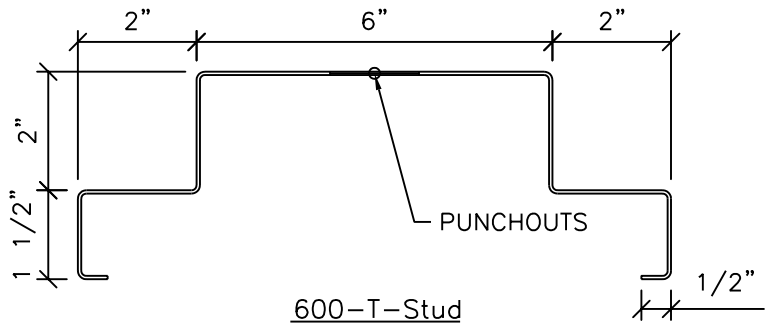

# SMOOTH PRODUCTS INC. D·R·Y·W·A·L·L F·R·A·M·I·N·G

TACOMA, WA

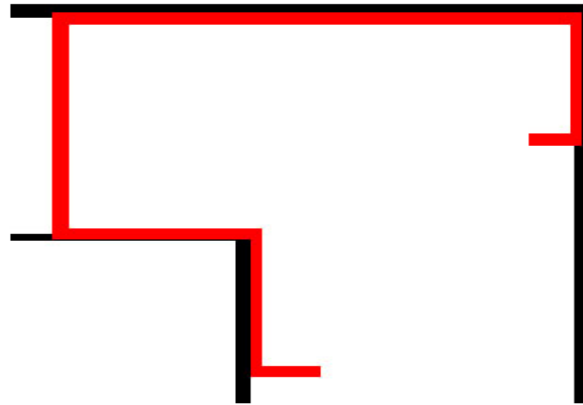

**Smooth Product Patent Pending**

## **The Corner Stud**

0250 Corner Stud	0250-C-S-22	GA *
0362 Corner Stud	0362-C-S-22	
0400 Corner Stud	0400-C-S-22	
0600 Corner Stud	0600-C-S-22	

- Great for use in smaller rooms
- Smarter, faster, better for tenant improvements
  - Provides solid corners for the tapers
- Saves time and money for the contractor and owner
- Punched holes for mechanical, electrical and plumbing trades
  - No need for back screwing studs
  - Avoid having to handle sharp edges
    - Use one stud instead of three
    - No need to find the slider stud

Ideal for hospital and tenant improvements or remodels

# SMOOTH PRODUCTS INC. D·R·Y·W·A·L·L F·R·A·M·I·N·G

TACOMA, WA

THAT WAS THEN....

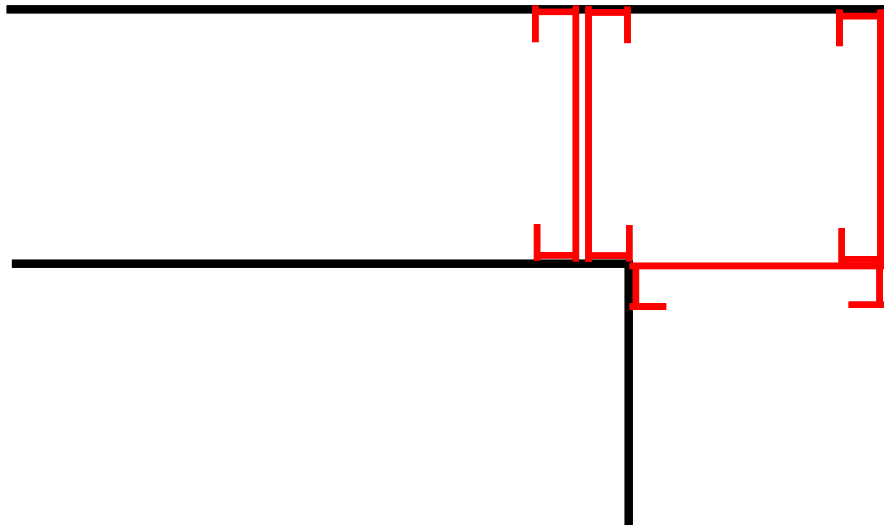

THIS IS NOW

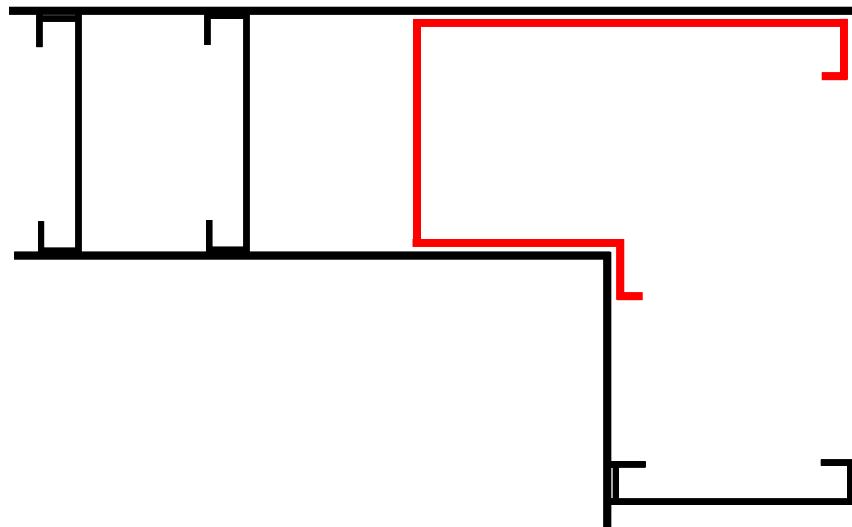

THE NEW CORNER STUD

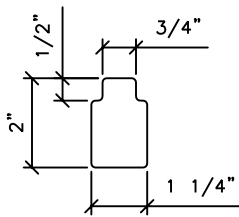
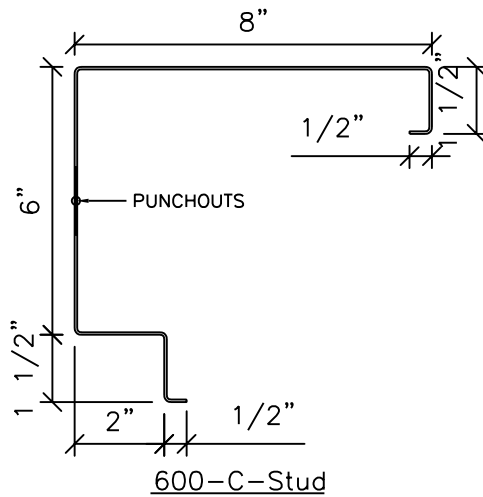
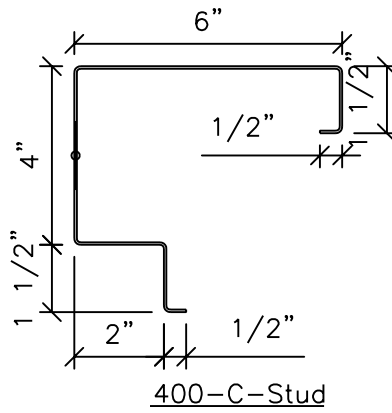
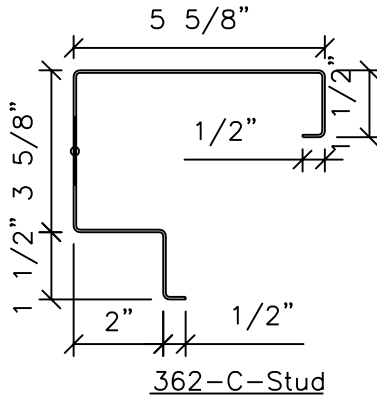
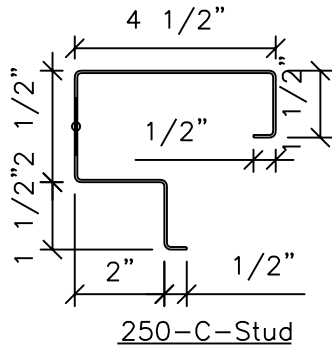

PUNCHOUTS @ 24 INCHES OC

# SMOOTH PRODUCTS INC. D·R·Y·W·A·L·L F·R·A·M·I·N·G

TACOMA, WA

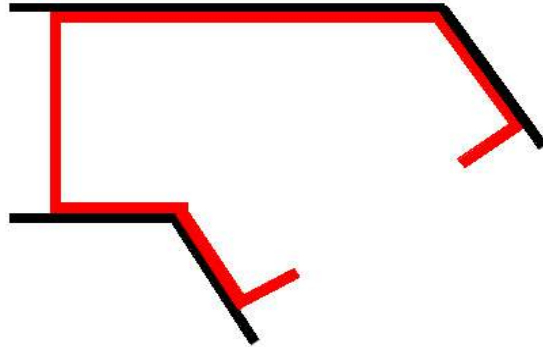

## Smooth Product Patent Pending

### The 45 Stud Wall

0250 45 STUD	0250-45-S-22	GA*
0362 45 STUD	0362-45-S-22	
0400 45 STUD	0400-45-S-22	
0600 45 STUD	0600-45-S-22	

- Great for using in small rooms
- Smarter, faster, better for tenant improvement
  - Solid outside/inside corners for the tapers
    - Easier to install taping trims
  - Save time and money for contractors and owners
- Punched holes for the mechanical, electrical, plumbing trades
  - No screwing studs together to make a 45 degree angle
- Since studs are at 45 degree angle, save time by not having to measure angles
  - No handling sharp edges
  - Use one stud instead of two
  - No more off angle flat stock



# SMOOTH PRODUCTS INC. D·R·Y·W·A·L·L F·R·A·M·I·N·G

TACOMA, WA

WHEN TIME & MONEY IS NO OBJECT

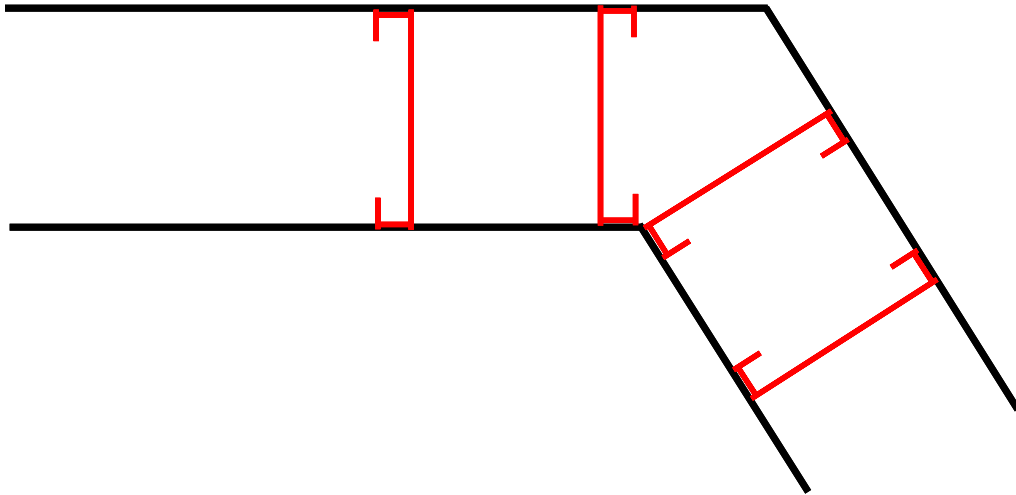

WHEN QUALITY AND VALUE IS....

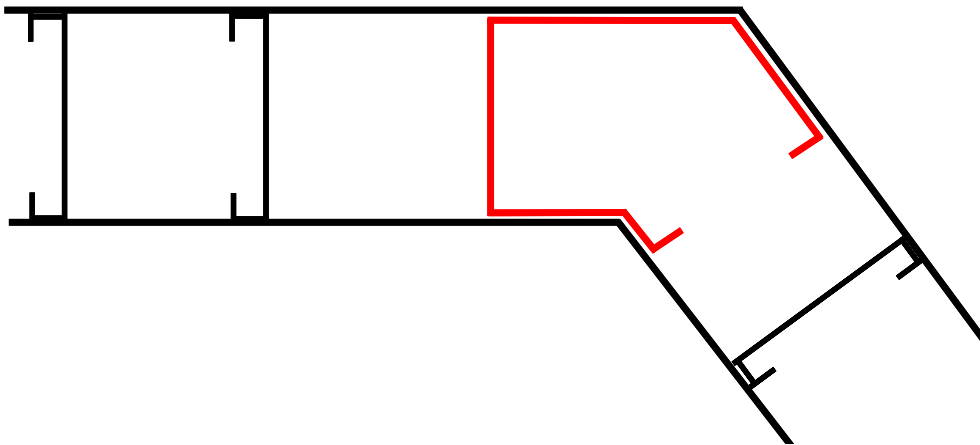

THE NEW 45 DEGREE STUD

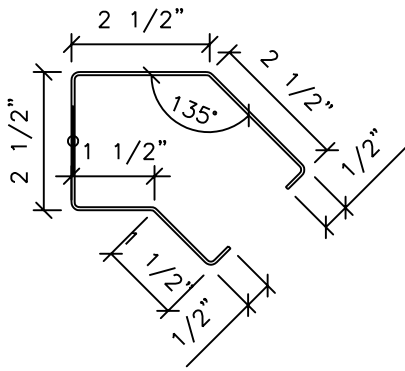

250-45-S Stud

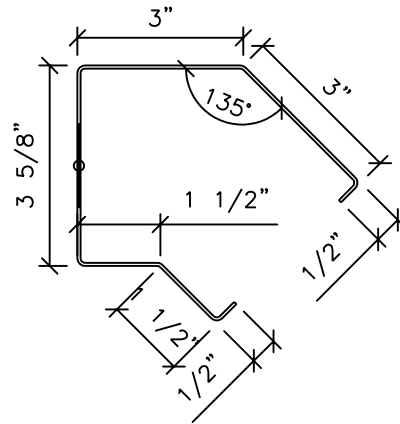

362-45-S Stud

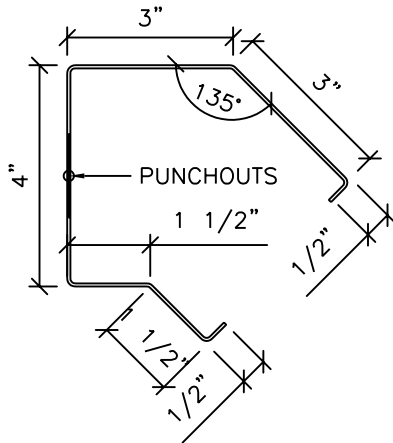

400-45-S Stud

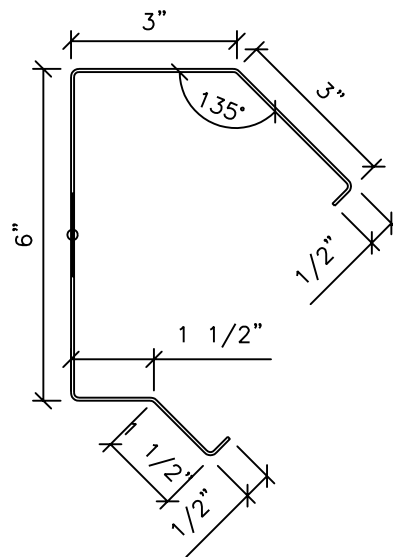

600-45-S Stud

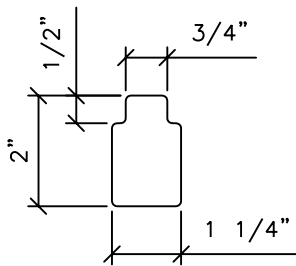

PUNCHOUTS @ 24 INCHES OC

# SMOOTH PRODUCTS D·R·Y·W·A·L·L F·R·A·M·I·N·G

TACOMA, WA

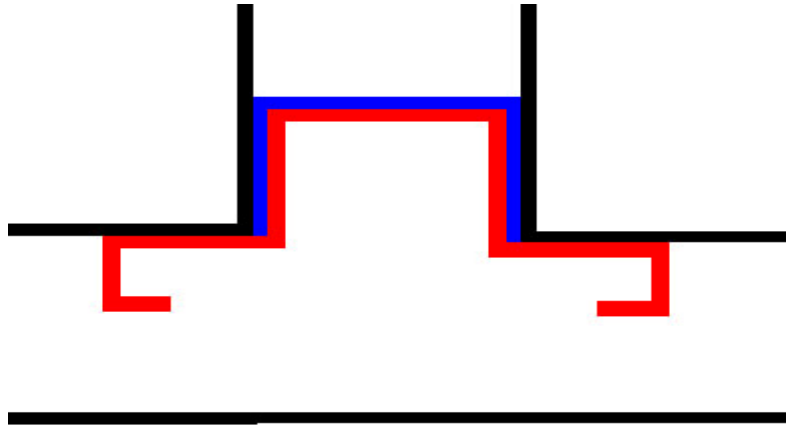

**Smooth Product Patent Pending**

## **The T Stud for 1 & 2 Hr Wall**

0362 T Stud 1HR/2HR	0362-T-S-1HR-22	GA*
0400 T Stud 1HR/2HR	0400-T-S-1HR-22	
0600 T Stud 1HR/2HR	0600-T-S-1HR-22	

Since the size of the stud is slimmer, drywall can be placed around the stud creating fire resistant walls.

- Great for use in smaller rooms
- Smarter, faster, better for tenant improvements
  - Provides solid corners for the tapers
- Saves time and money for the contractor and owner
- Punched holes for mechanical, electrical and plumbing trades
  - No need for back screwing studs
  - Avoid having to handle sharp edges
    - Use one stud instead of three
    - No need to find the slider stud
- Ideal for hospital and tenant improvements or remodels

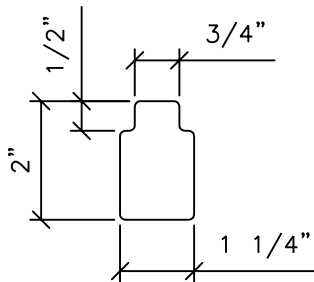
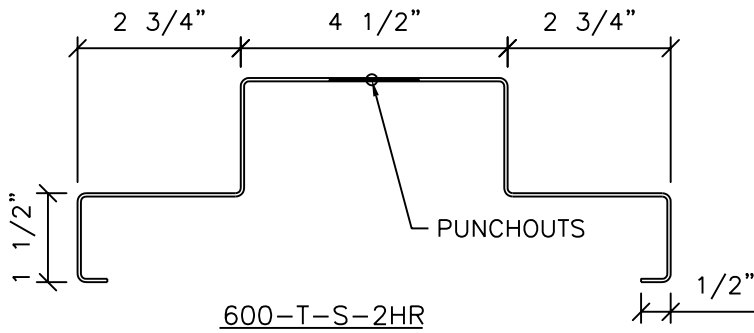
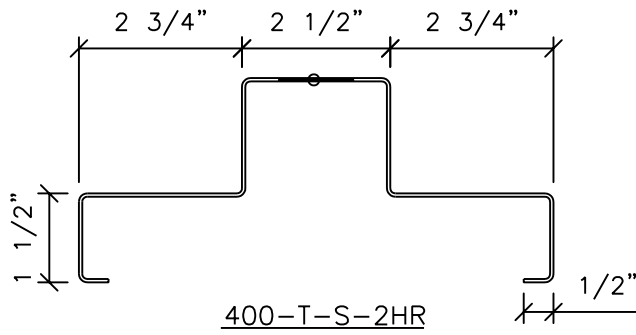
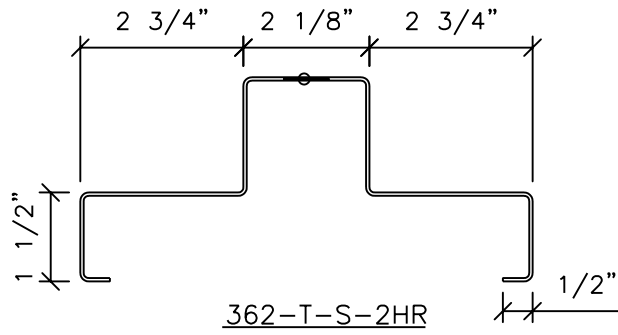

PUNCHOUTS @ 24 INCHES OC

# SMOOTH PRODUCTS INC. D·R·Y·W·A·L·L F·R·A·M·I·N·G

TACOMA, WA

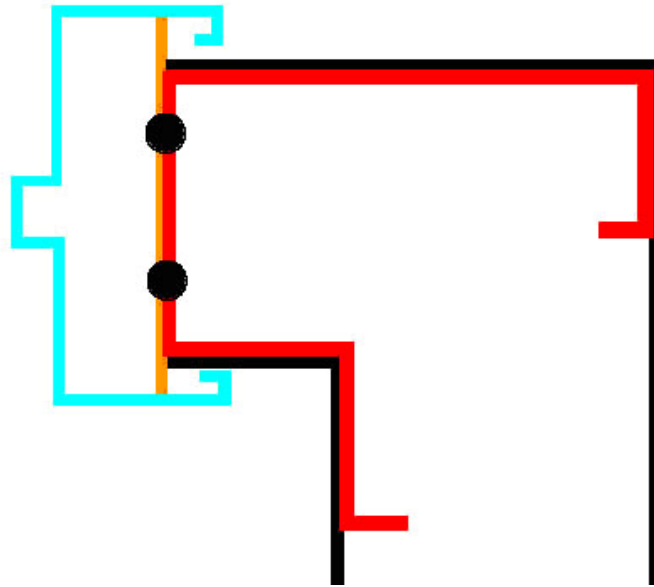

**Smooth Product Patent Pending**

## **The Corner Stud Door**

0362 Corner Stud Door    0362-C-S-D-22    GA\*  
0400 Corner Stud Door    0400-C-S-D-22  
0600 Corner Stud Door    0600-C-S-D-22

- Great for door frames off walls
- Corner door studs made to your specification
  - Great for timely frames
  - Easy to use with wood framing
- Save time and money for hangers, contractors, and owners
  - Provides solid connection to door frame

Ideal for hospital remodels and tenant improvements

\* Smooth Products will create 16,18,20,21,22 Gauges

Patent Pending

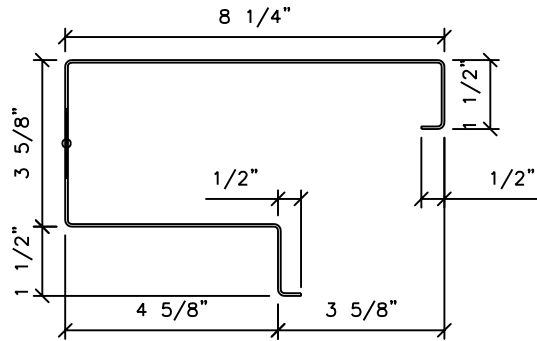

362-C-S-D Stud

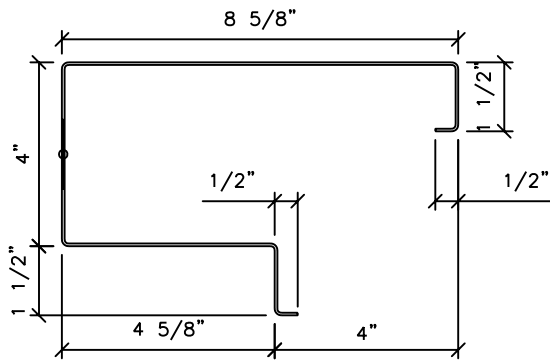

400-C-S-D Stud

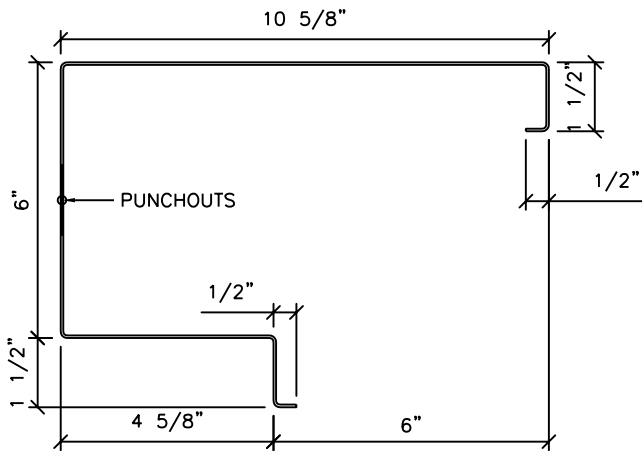

600-C-S-D Stud

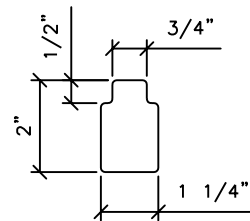

PUNCHOUTS @ 24 INCHES OC

# SMOOTH PRODUCTS INC.

## D·R·Y·W·A·L·L F·R·A·M·I·N·G

TACOMA, WA

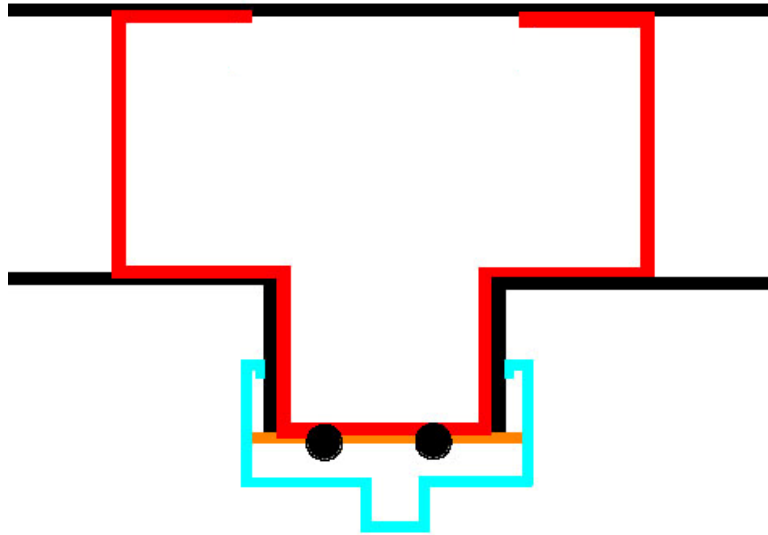

**Smooth Product Patent Pending**

### **The T Door Stud**

0362 T Stud Door    0362-T-S-D-22    GA\*  
0400 T Stud Door    0400-T-S-D-22  
0600 T Stud Door    0600-T-S-D-22

- Great for door frames off walls
- T Door Studs made to your specification
  - Great for timely frames
  - Easy to use with wood framing
- Save time and money for hangers, contractors, and owners
  - Provides solid connection to door frame

Ideal for hospital remodels and tenant improvements

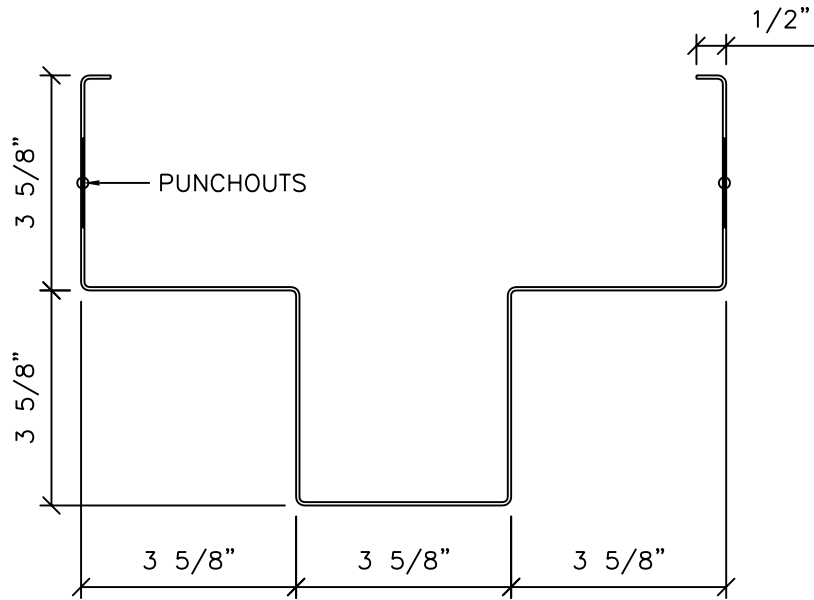

362-T-S-D

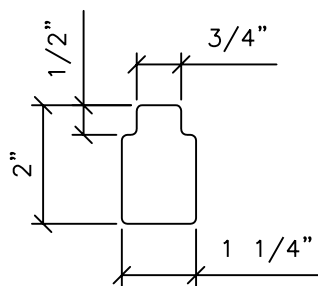

PUNCHOUTS @ 24 INCHES OC





**3 Walls using T-Stud with Track Installation**



**Board Installation using  
Smooth Products  
T-Stud**

A photograph showing the corner of a metal wall frame. The frame consists of several vertical and horizontal metal studs. A specific vertical stud is highlighted with a blue rectangular label. The floor is made of concrete. In the upper left corner, a green cable is visible. The overall scene is dimly lit, typical of an indoor construction or renovation site.

**T-Stud**

**3 Walls Using  
Smooth Products  
T-Stud**

**Ceiling  
with  
Wallboard  
Corner-Stud**





**Smooth Products  
Corner Studs 2006  
C-Stud**

**C  
Stud**

**T  
Stud**

**Wall Example with Smooth Products  
T & C Studs Installation**



**1st Installation of  
Smooth Products  
used in a Portland, OR.  
Hospital**



# SMOOTH PRODUCTS INC. D·R·Y·W·A·L·L F·R·A·M·I·N·G

TACOMA, WA

PATENT PENDING

Inside Corner Stud for 90° Angle Wall

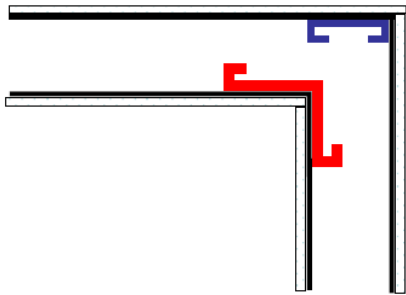

Outside Corner Stud with Adjustable Angle Degree  
Inside Corner Stud with Adjustable Angle Degree

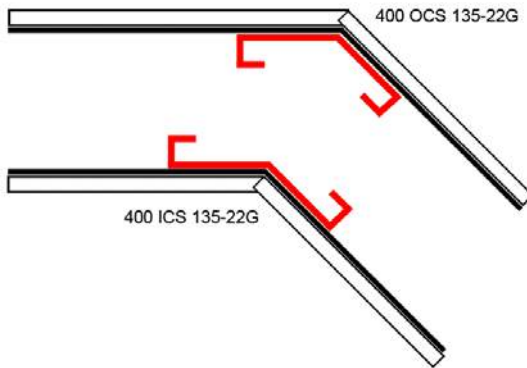

Inside Corner Stud 90° for Wall Intersection

